

028

前脚収納庫扉 Nose Landing Gear Door

■ 接着位置
Cementing position

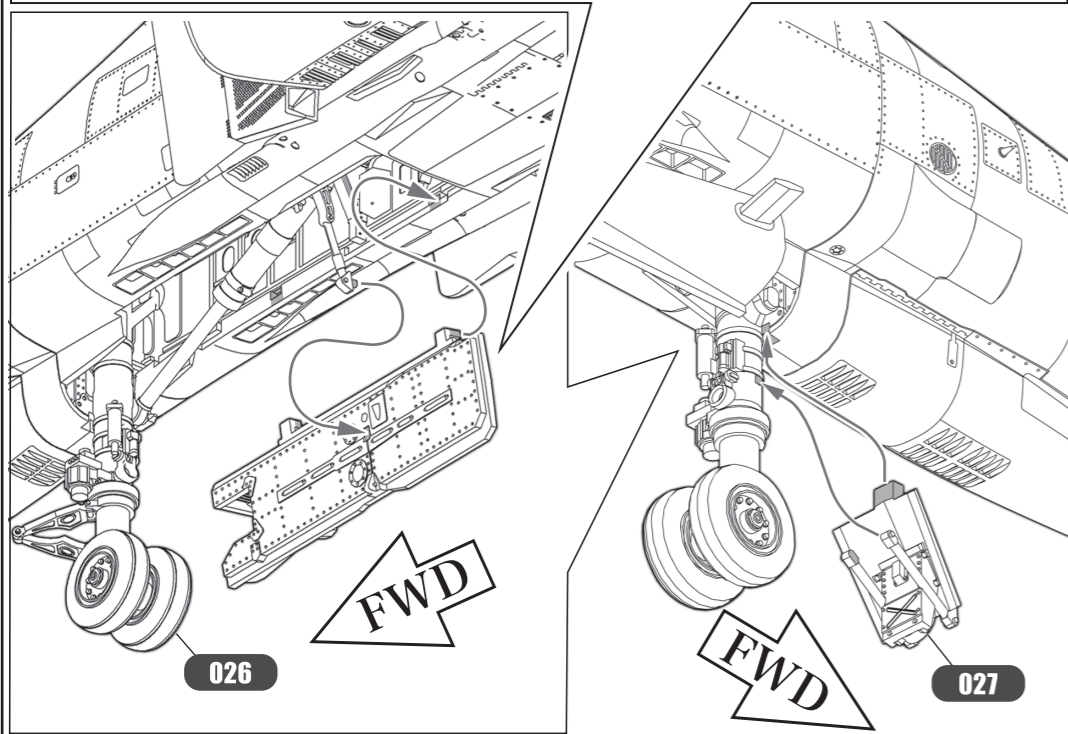
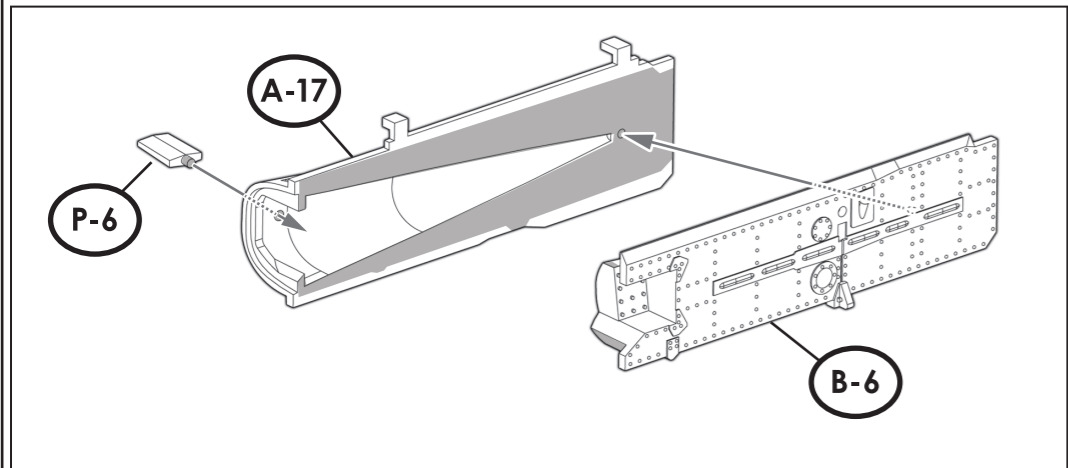

実機におけるパーツ名
Name of the parts of the real aircraft.

- A-17 前脚収納庫扉 / Nose Landing Gear Door
- B-6 前脚収納庫扉 / Nose Landing Gear Door
- P-6 V/UHFアンテナ / V/UHF Antenna

各パーツ接着位置
Parts configuration after assembly.

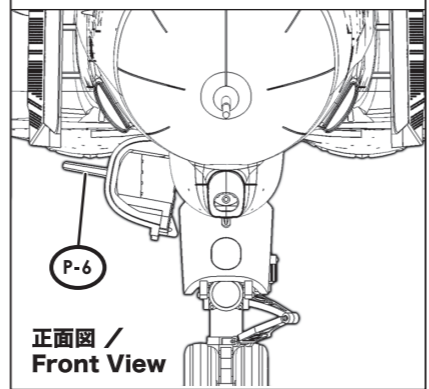
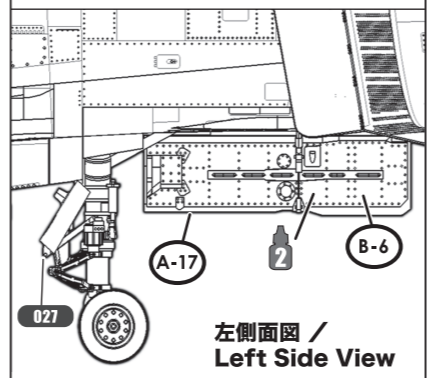
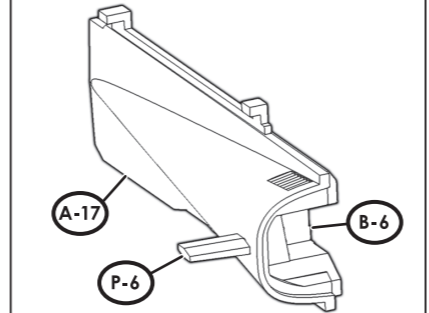

029

主脚支柱とタイヤ Main Landing Gear Struts and Tires

SWS Design Concept

大きなシングルタイヤは、EJ改でも米空軍型と同じ76.2cm×29.2cmという幅の広いタイプで、低圧タイヤ(200psi)です。The large single tires on the F-4E and F-4EJ Kai had a wide size of 76.2 cm by 29.2 cm, the same type as the USAF F-4 variations, with a low pressure of 200 psi.

■ 接着位置
Cementing position

右側 / Right

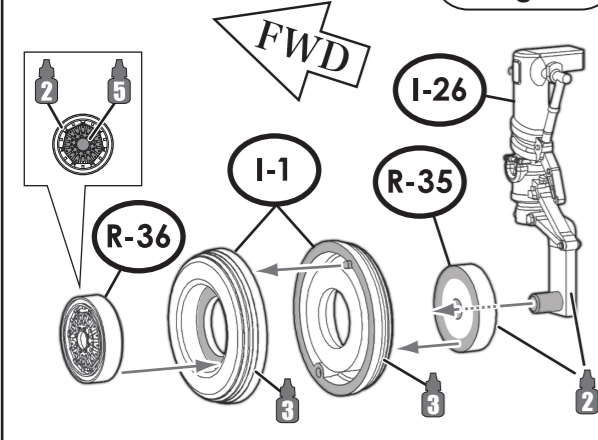

左側 / Left

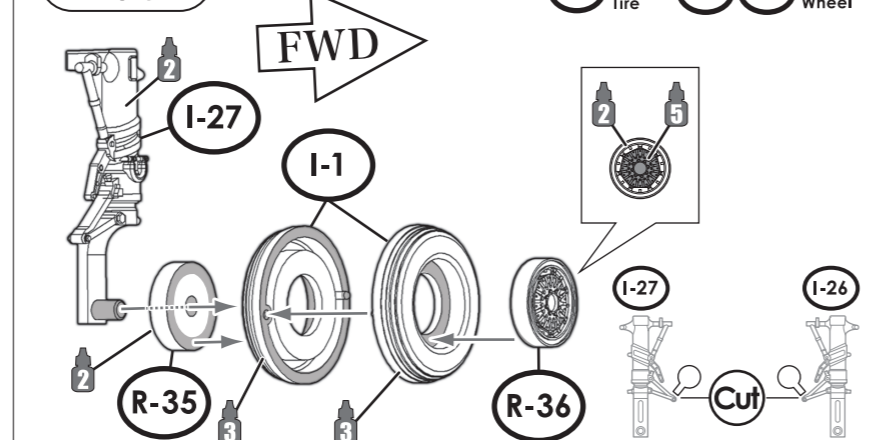

実機におけるパーツ名
Name of the parts of the real aircraft.

- I-26 主脚支柱(右側) / Main Landing Gear Strut (Right)
- I-27 主脚支柱(左側) / Main Landing Gear Strut (Left)
- I-1 タイヤ / Tire
- R-35 ホール / Wheel
- R-36 ホール / Wheel

030

主脚 Main Landing Gears

SWS Design Concept

主脚は油圧により内側へ引き込まれます。The main landing gear was hydraulically retractable into the fuselage.

実機におけるパーツ名
Name of the parts of the real aircraft.

- M-40 主脚扉(右側) / Main Landing Gear Door (Right)
- I-7 主脚アクチュエーター(右側) / Main Landing Gear Actuator (Right)
- M-30 小主脚扉(右側) / Small Main Landing Gear Door (Right)

右翼 / Right Wing

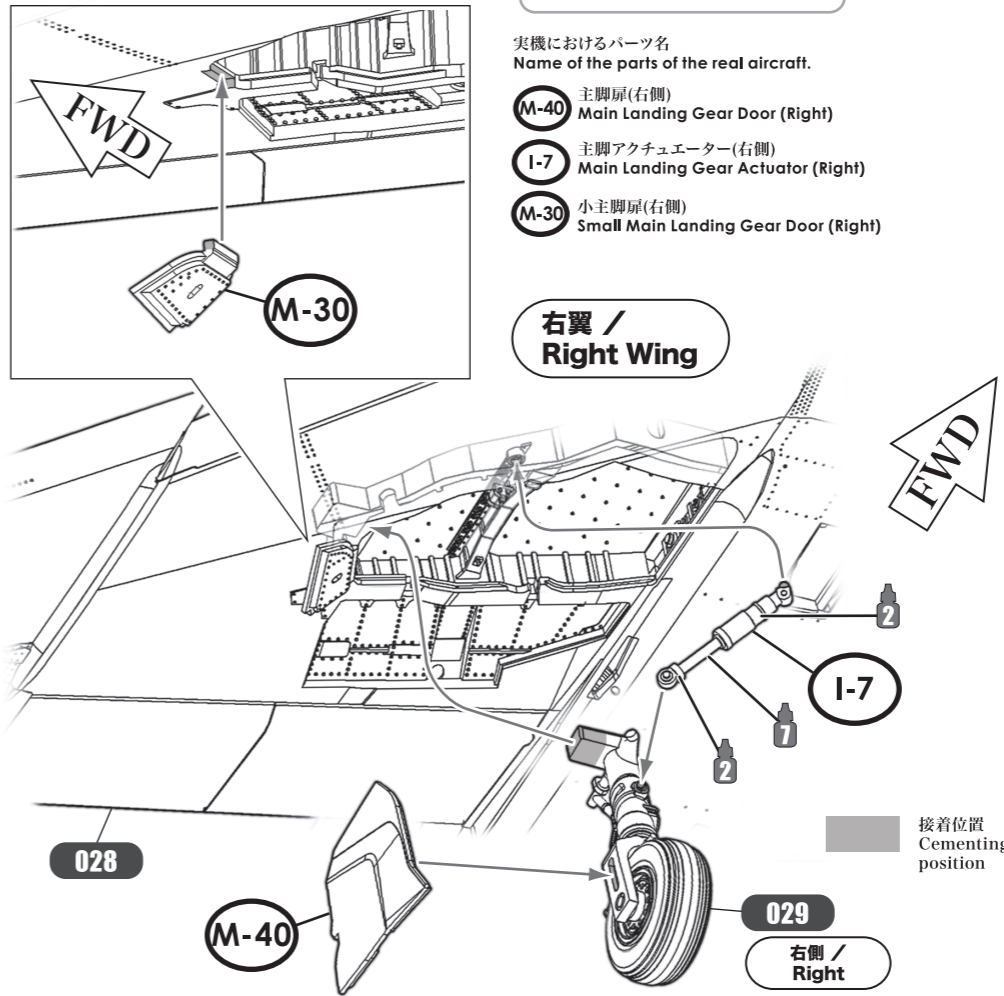

左翼 / Left Wing

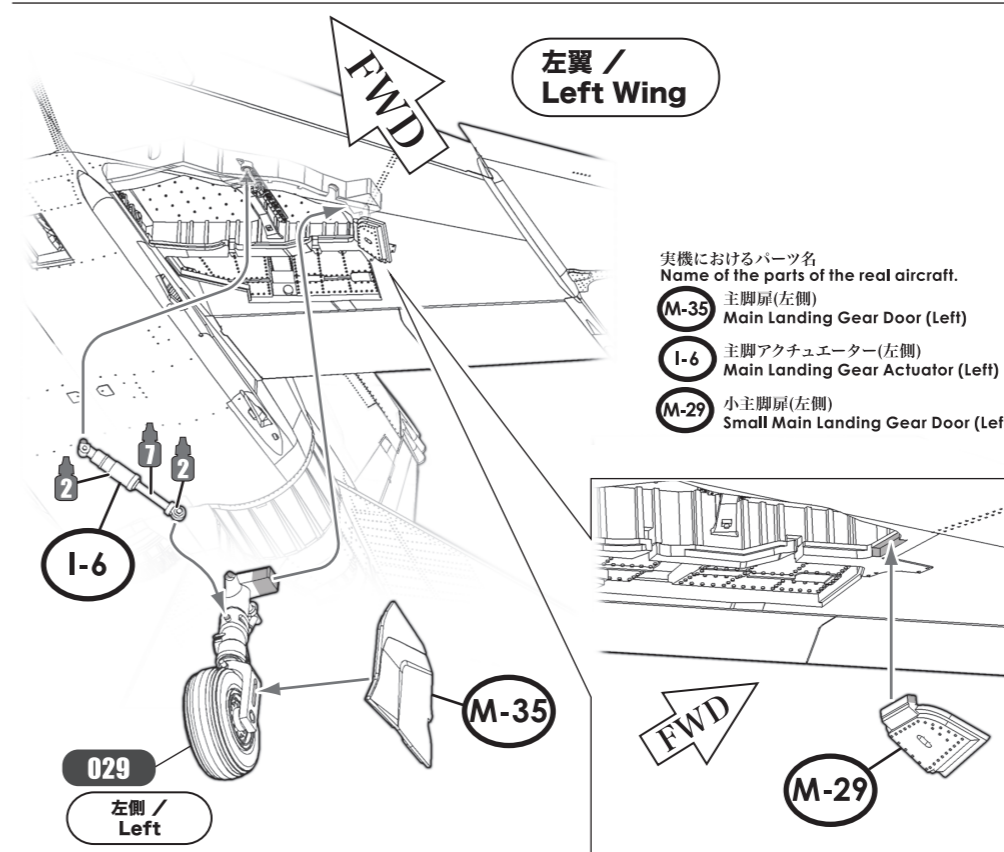

各パーツ接着位置
Parts configuration after assembly.

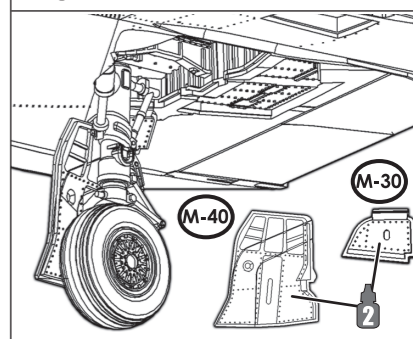
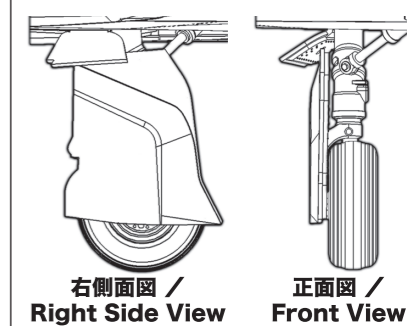
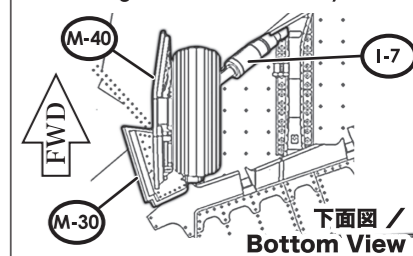

各パーツ接着位置
Parts configuration after assembly.

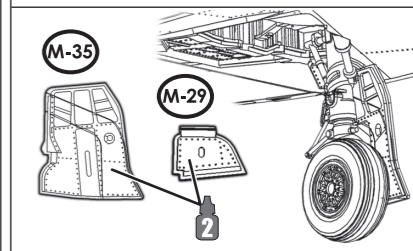
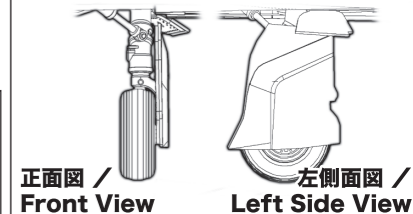
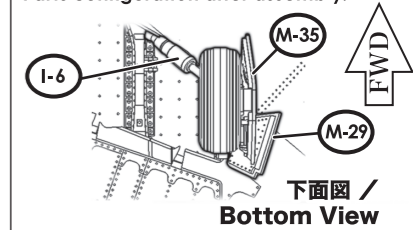

実機におけるパーツ名
Name of the parts of the real aircraft.

- M-35 主脚扉(左側) / Main Landing Gear Door (Left)
- I-6 主脚アクチュエーター(左側) / Main Landing Gear Actuator (Left)
- M-29 小主脚扉(左側) / Small Main Landing Gear Door (Left)