

# 025 スタビレーター Stabilator

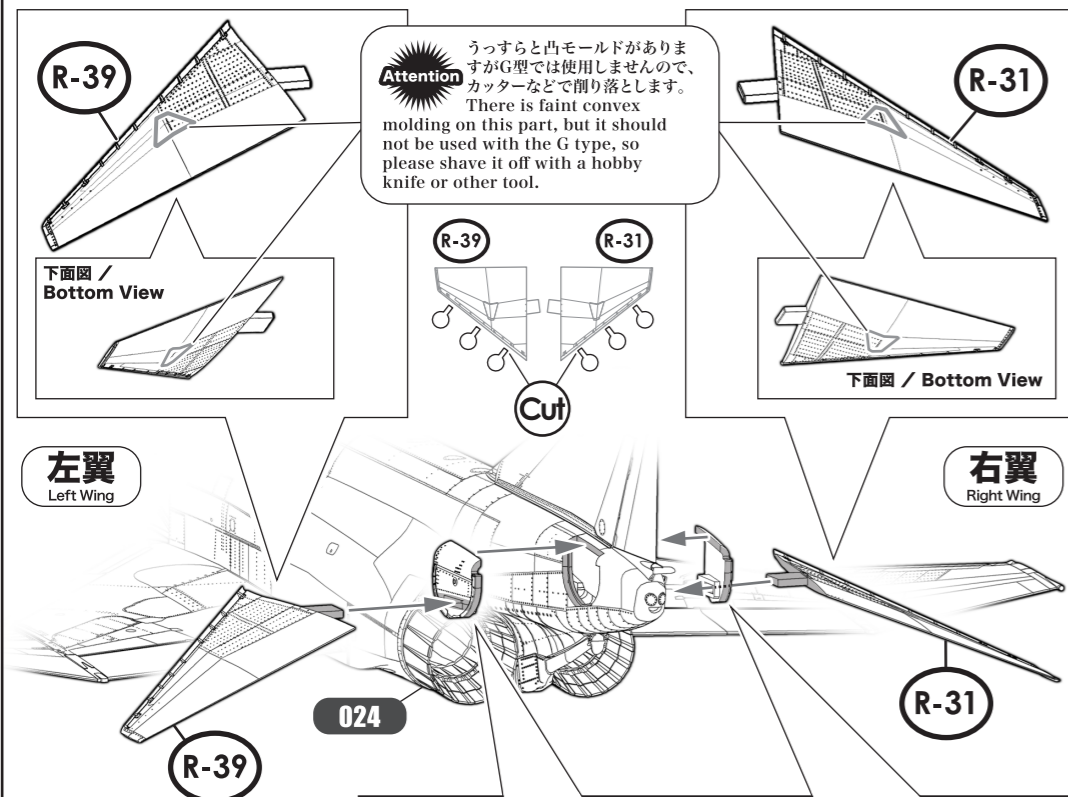

## スタビレーター取り付け部の 角度選択

Choose the angle of the stabilator mounting part

**Attention**  
 スタビレーターの角度を「水平」「下向き」「上向き」の3状態を選択することが出来ます。使用するパーツの左右を合わせて、形状をよく確認して組み立ててください。You can choose for the angle of the stabilator to be level, downward- or upward-facing. Use the same angle for both the left and right sides, and be careful to confirm the shape.

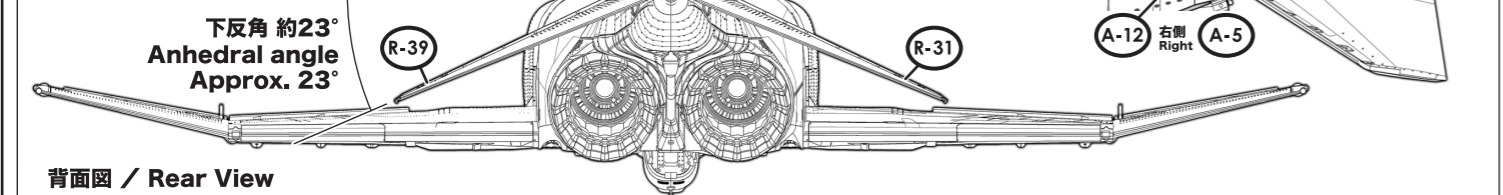
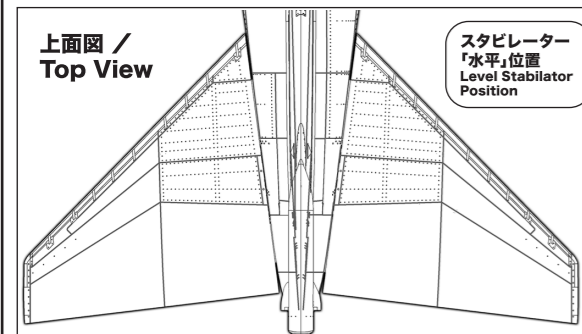
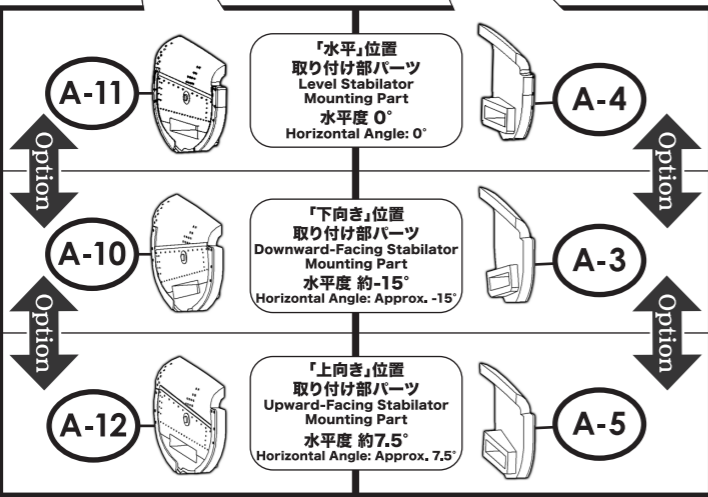

# 026 前脚 Nose Landing Gear

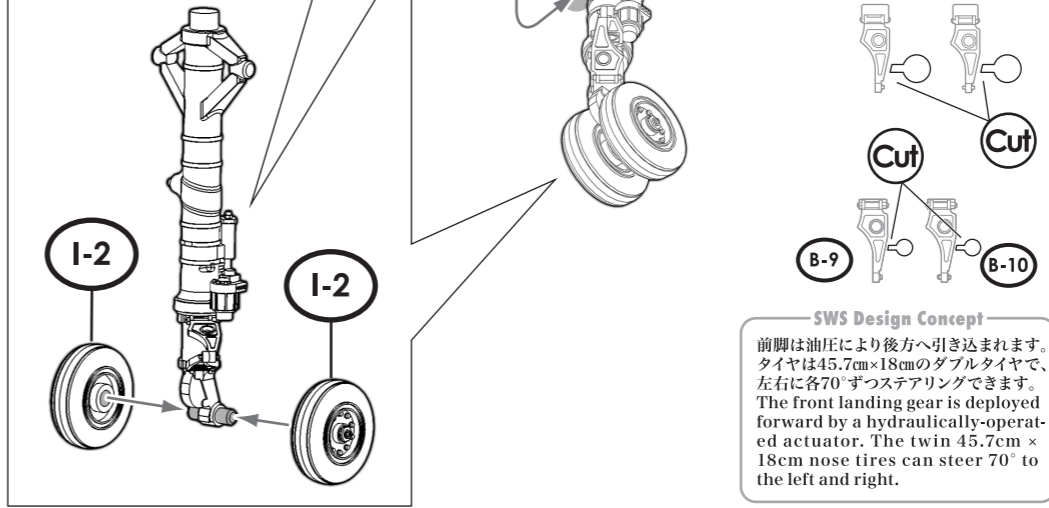
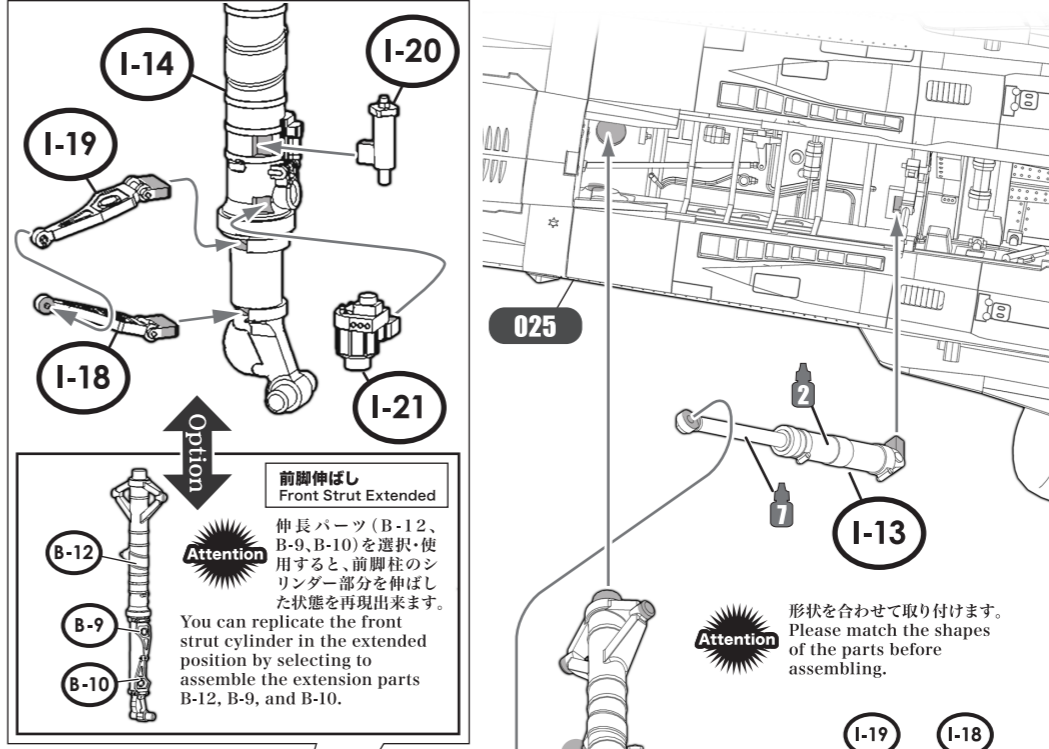

# 027 前脚収納庫前扉 Nose Landing Gear Front Door

