

3-4. N エンジン排気管 Engine Exhausts

右側 / Right Side

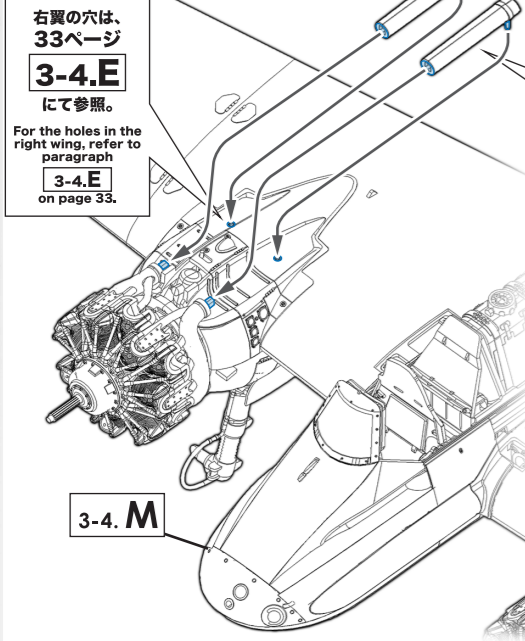

左側 / Left Side

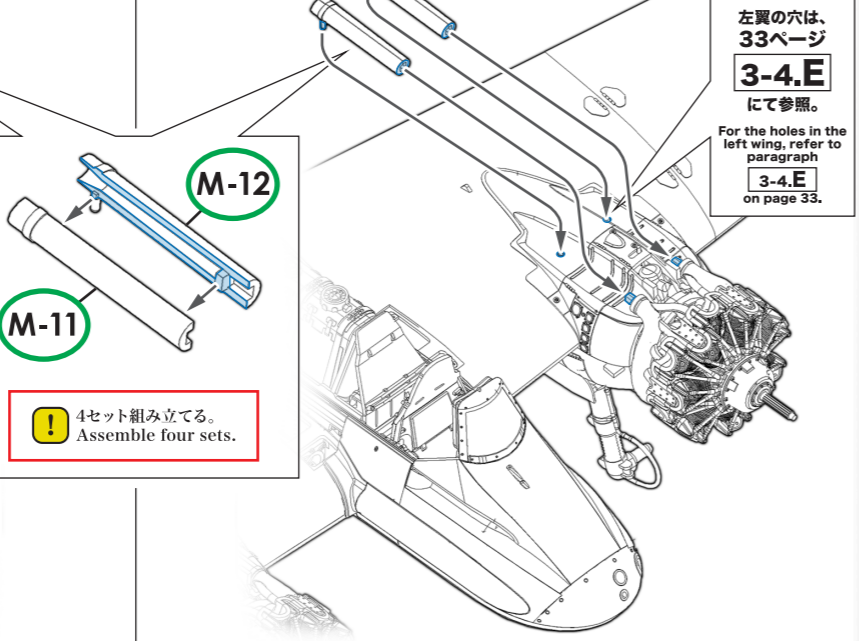

実機におけるパーツ名
Name of the parts implemented in the actual aircraft. (M-11) (M-12) エンジン排気管 Engine Exhausts

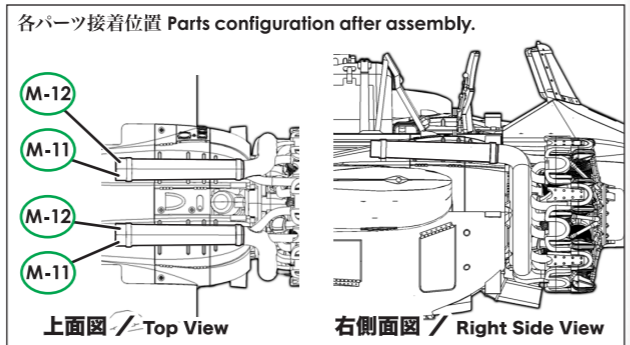
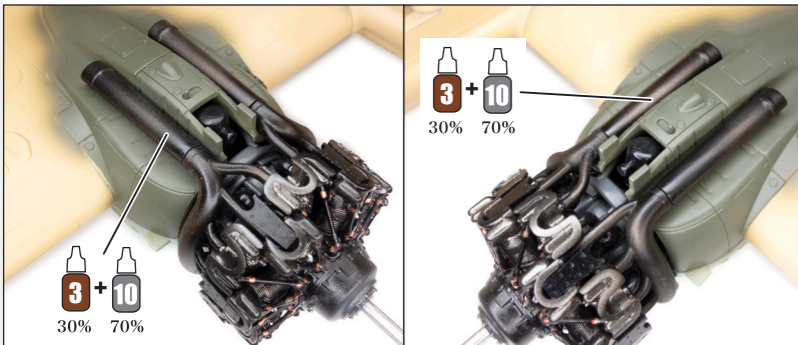

3-4. O 主脚タイヤ Main Landing Gear Tire

右側 / Right Side

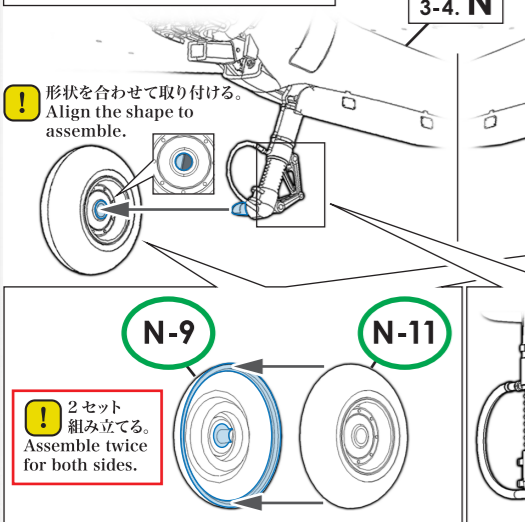

左側 / Left Side

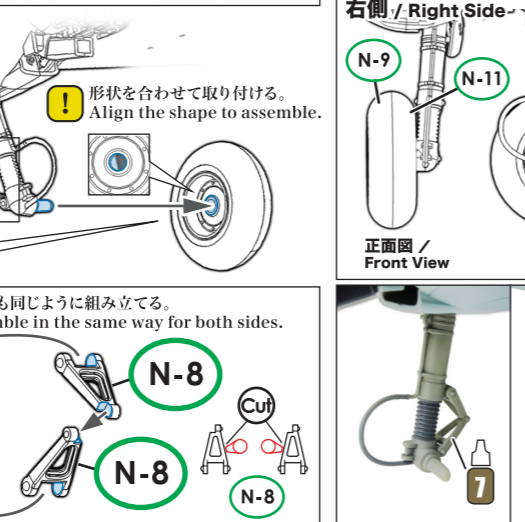

実機におけるパーツ名
Name of the parts implemented in the actual aircraft. (N-9) (N-11) タイヤ Tire (N-8) トルクアーム Torque Arm

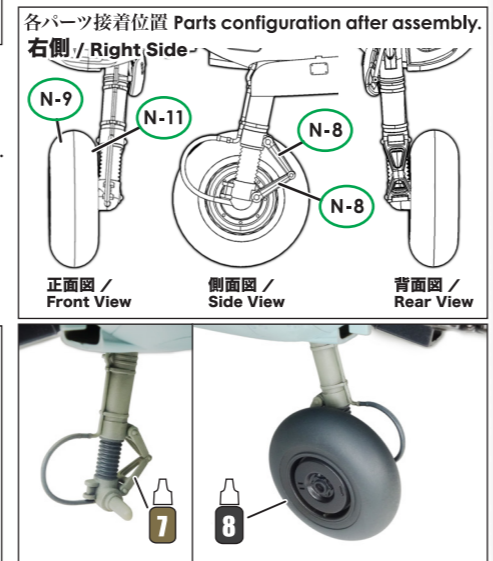

3-4. P カウリング Cowling

右側 / Right Side

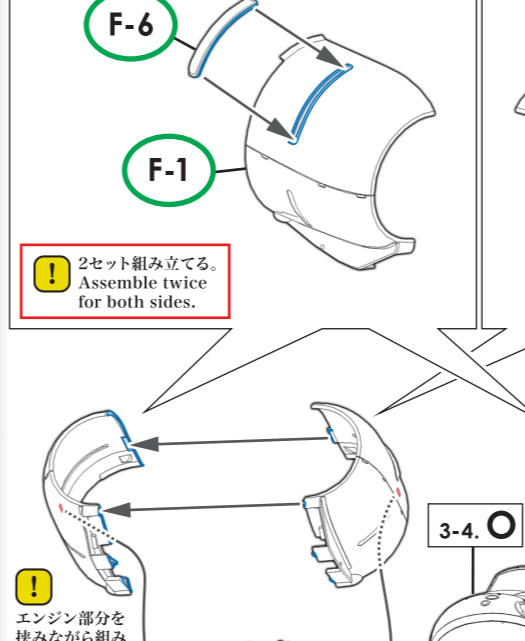

左側 / Left Side

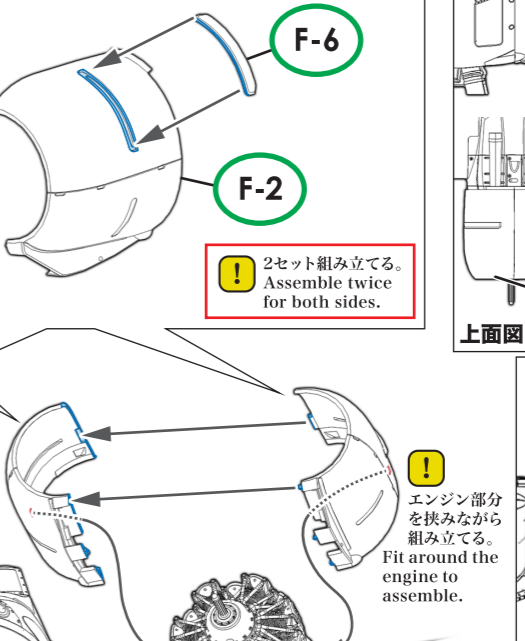

実機におけるパーツ名
Name of the parts implemented in the actual aircraft. (F-1) (F-2) カウリング Cowling (F-6) カウリングルーバーカバー Cowl Louver Cover

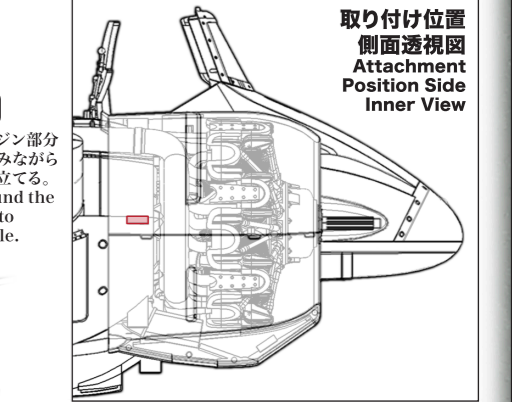
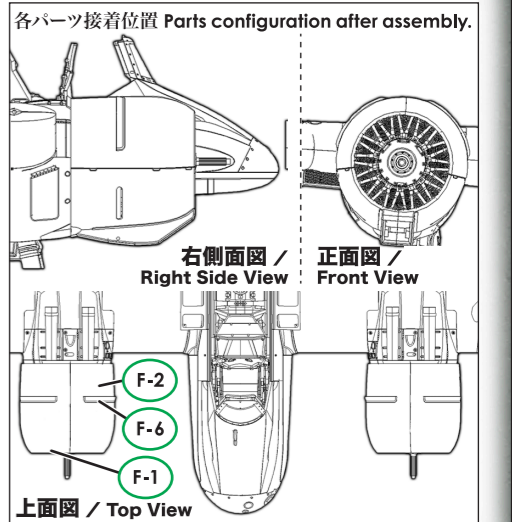
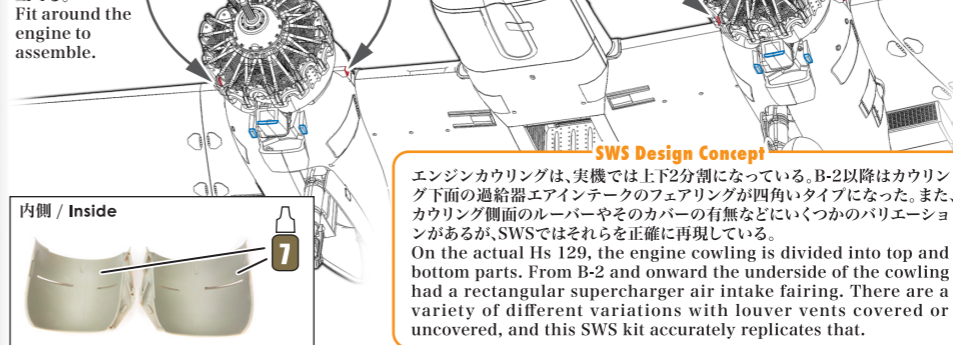

3-4. Q インテークフィルター Intake Filter

右側 / Right Side

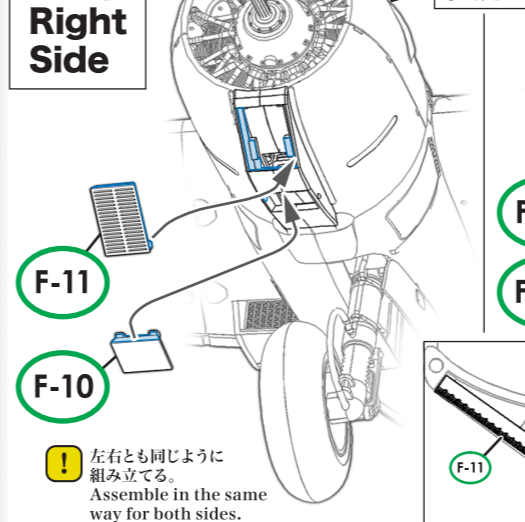

左側 / Left Side

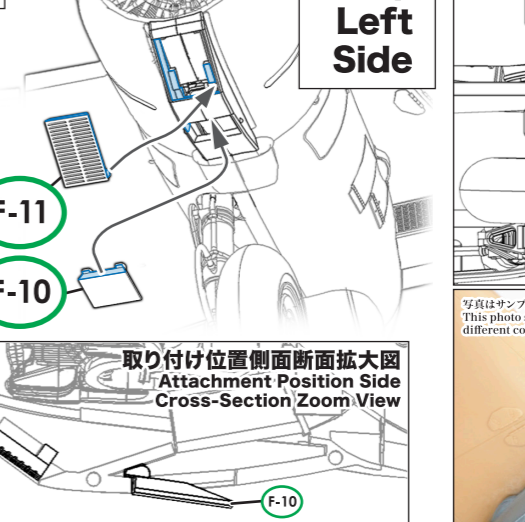

実機におけるパーツ名
Name of the parts implemented in the actual aircraft. (F-11) インテークフィルター Intake Filter (F-10) ホドレイン Water Drain

