

Attention!

- This item is meant for hobbying by 15 years of age or older. Please do not give this item to children under 15.
- This item is intended for use with the Zoukei-mura 1/32 "Kettenkrad"
- The polyethylene bags that contain the parts and assembly manual present a suffocation risk. Please do not drop the parts or bend them in unintended ways, as they may be damaged.
- In order to properly express the shape of the sculptures, it was unavoidable for some parts to have sharp edges. Please be careful.

ZOUKEI-MURA INC. PRESENTS
SUPER WEAPON SERIES
1/32
Kettenkrad
These are extra parts to be used with the "Kettenkrad" kit.

造形村
ZOUKEI-MURA INC.

http://www.zoukeimura.co.jp/
 ■ Plan & Manufacturer : Zoukei-Mura, Inc.
 ■ Distributor : VOLKS, Inc.
 http://www.volks.co.jp/en/index.aspx
 60 Gomonachi Nakamachi 3-chome-3
 Shimogyo-ku, Kyoto Japan 600-8862

SUPER WEAPON OPTIONS

ZOUKEI-MURA INC. PRESENTS SUPER WEAPON SERIES No.01

Sd.Kfz.2

SWPS01-M02

Kettenkrad

Power Supply Car

ZOUKEI-MURA INC. PRESENTS
SUPER WEAPON SERIES

1/32
Kettenkrad
These are extra parts to be used with the "Kettenkrad" kit.

These parts are made of urethane resin. Please be careful during assembly.

Plastic model cement won't work on these parts. Please use a suitable instant glue.

造形村
ZOUKEI-MURA INC.

©ZOUKEI-MURA INC. All Rights reserved.
 ■ Plan & Manufacturer : Zoukei-Mura, Inc.
 ■ Distributor : VOLKS, Inc.

SUPER WEAPON OPTIONS
 SUPER WEAPON SERIES No.01
 Sd.Kfz.2
Kettenkrad
 SUPER WEAPON SERIES
 1/32 Kettenkrad
 These are extra parts to be used with the "Kettenkrad" kit.



How to assemble the "Power Supply Car" to the 1/32 "Kettenkrad" kit

Assemble the Power Supply Car as described below. The Power Supply Car can be towed by the "Kettenkrad" or placed next to your "TaI52H-1" kit as you like.

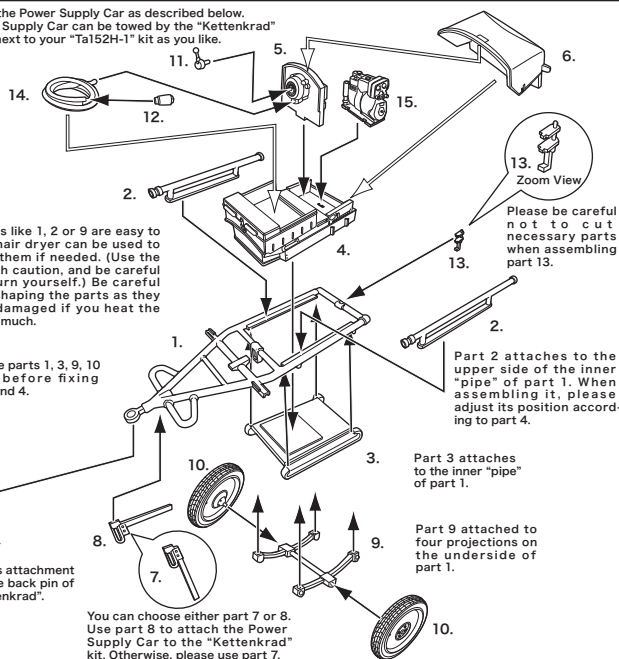

Thin parts like 1, 2 or 9 are easy to warp. A hair dryer can be used to reshape them if needed. (Use the dryer with caution, and be careful not to burn yourself.) Be careful when reshaping the parts as they may be damaged if you heat the parts too much.

Please be careful not to cut necessary parts when assembling part 13.

Assemble parts 1, 3, 9, 10 and 13 before fixing parts 2 and 4.

Part 2 attaches to the upper side of the inner "pipe" of part 1. When assembling it, please adjust its position according to part 4.

Part 3 attaches to the inner "pipe" of part 1.

Part 9 attached to four projections on the underside of part 1.

Insert this attachment hole in the back pin of the "Kettenkrad".

You can choose either part 7 or 8. Use part 8 to attach the Power Supply Car to the "Kettenkrad" kit. Otherwise, please use part 7.

Attachment Point on the 1/32 "Kettenkrad" kit

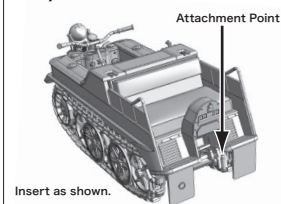

Insert as shown.



The 1/32 "Kettenkrad" is sold separately. The kit is not included in the set.

◆◆Important Points for Assembly◆◆

- Please carefully read the assembly manual prior to opening and make sure that everything is included.
- To use this item, tools such as ① nippers, ② craft knife, ③ files, ④ sanding papers, ⑤ instant glue, etc., are required, so please prepare them.
- Please prepare the parts first. You can remove seam lines and gate marks with tools such as nippers, a craft knife and files. Urethane resin is softer than the plastic material used for the kit, so be careful to avoid carving too much. Air bubbles can be filled with putty (epoxy, plastic, etc.) or similar, then finished with sanding paper. In the case that mold details are lost, you can recover them with tools such as spatulas.
- During assembly, adjust the orientation of each part while checking the balance and pose of the entire kit.
- Instant glue should be used for these parts. Please note that they cannot be glued with plastic model kit cement.
- We recommend using brass wire (sold separately) to reinforce the areas where the parts are glued together. Use a pin vise and drill bit to open a hole on both sides of each gluing surface, then insert the ends of a brass wire into the holes to connect the sides. This will greatly increase the strength of each joint. (Using the wires without glue to temporarily build a figure is called dry fitting. We recommend doing so in order to check each figure's balance.)
- Base preparation is required before painting. Please thoroughly finish the base with a coat of surfacer spray (otherwise, the paint will chip off as time passes).
- The recommended brand for painting your kit is the latest line of paint from Vallejo Color. While referring to historical resources on the Luftwaffe, you may paint the model with the coloring of your choice.

Chart of Included Parts

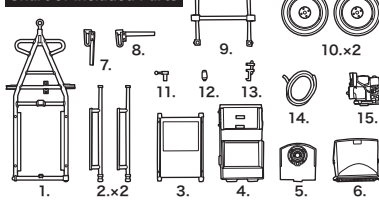

We take the utmost of care when overseeing manufacturing, but if your kit is among the very small percentage that contains a defective part, please contact customer service within two weeks of your purchase with your full name and order number.

Purchasers from VOLKS
Japan International Web Site:
 Please contact imos@volks.co.jp.
Purchasers from VOLKS USA:
 Please contact service@volksusa.com.

※When it comes time to use tools and paints, please carefully follow the individual instructions respective to each tool for your safety.