

Attention!

- This item is meant for hobbyists 15 years of age or older. Please do not give this item to children under 15.
- This item is intended for use with the Zoukei-mura 1/32 "Ki-45 Kai TORYU".
- The polyethylene bags that contain the parts and assembly manual present a suffocation risk. Please do not drop the parts or bend them in unintended ways, as they may be damaged.
- In order to properly express the shape of the sculpts, it was unavoidable for some parts to have sharp edges. Please be careful.

This is a resin kit. Please note that these parts cannot be glued with plastic model kit cement. Instant glue should be used instead.

SUPER WING OPTIONS



SWS131-F05

1/32 ZOUKEI-MURA INC. PRESENTS SUPER WING SERIES. No.13

Kawasaki Ki-45 Kai
Two-Seater Fighter
看龍 (Ko, Hei, Tei)
TORYU (UNICK)

Toryu Pilot Boarding Set

1/32 TORYU (UNICK)



Exclusive Pilot Figure

看龍 (Ko, Hei, Tei)

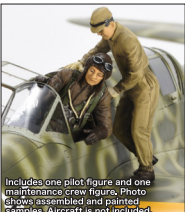

Includes one pilot figure and one maintenance crew figure. Photo shows assembled and painted parts. Aircraft is not included.

©2012 ZOUKEI-MURA INC. All Rights reserved.

MB
MASTER BOX LTD.
ZOUKEI-MURA INC.
http://www.zoukeimura.co.jp/
Zoukei-Mura, Inc.
MASTER BOX LTD.
Design for
60 Gessenouchi Nakamachi
Shichijo, Shimogyo-ku, Kyoto
Japan 600-8862

Toryu Pilot Boarding Set
4 518992 230146

◆◆ Important Points for Assembly ◆◆

- Please carefully read the assembly manual prior to opening and make sure that everything is included.
- Use this item, tools such as nippers, a craft knife, a file, sanding papers, instant glue, etc., are required, so please prepare them.
- Please prepare the parts first. You can remove seam lines and gate marks with tools such as nippers, a craft knife and files. Urethane resin is softer than the plastic material used for the kit, so be careful to avoid carving too much. Air bubbles can be filled with putty (epoxy, plastic, etc.) or similar, then finished with sanding paper. In the case that mold details are lost, you can recover them with tools such as spatulas.
- During assembly, adjust the orientation of each part while checking the balance and pose of the entire kit.
- Instant glue should be used for these parts. Please note that they cannot be glued with plastic model kit cement.
- We recommend using brass wire (sold separately) to reinforce the areas where the parts are glued together. Use a pin vise and drill bit to open a hole on both sides of each gluing surface, then insert the ends of a brass wire into the holes to connect the sides. This will greatly increase the strength of each joint. (Using the wires without glue to temporarily hold a figure is called drift fitting. We recommend doing so in order to check each figure's balance.)
- Base preparation is required before painting. Please thoroughly finish the base with a coat of surfacer spray (otherwise, the paint will chip off as time passes).
- The recommended brand for painting your kit is the environment-friendly latest line of paint from Vallejo Color. Please refer to the Zoukei-mura 1/32 "Ki-45 Kai TORYU" Instruction Manual and Imperial Japanese Army historical manuals to paint the model with the coloring of your choice.

※When it comes time to use tools and paints, please carefully follow the individual instructions respective to each tool for your safety.

Chart of Included Parts

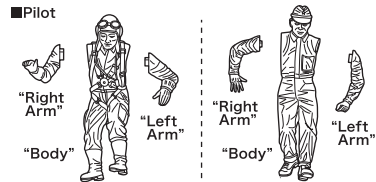

We take the utmost of care when overseeing manufacturing, but if your kit is among the very small percentage that contains a defective part, please contact customer service within two weeks of your purchase with your full name and order number.

Purchasers from VOLKS Japan International Web Site : Please contact imos@volks.co.jp
Purchasers from VOLKS USA : Please contact service@volksusa.com

1/32 "Toryu" Assembly Instructions

*These parts will be inserted when assembling the 1/32 "TORYU" kit. Please refer to the instruction manual of the "TORYU Tei". Page numbers may vary for Ko and Hei versions.

◆ Maintenance Crew and Pilot Assembly

Pay attention to the "Important Points for Assembly" when you assemble the resin parts of this set. Please see the Color Reference for painting.

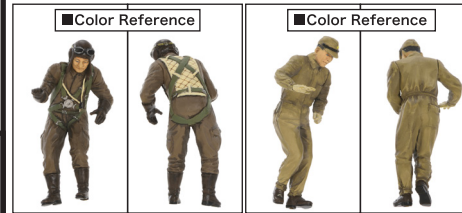
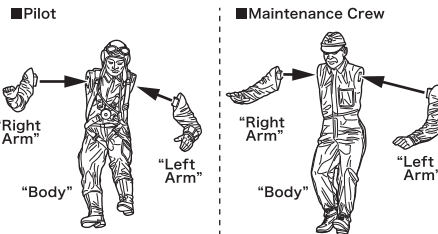

Vallejo Color Guide		MC=Model Color	GC=Game Color
vallejo		(*) = Vallejo Catalog Number	
Pilot's Skin color: 70955 (MC018) FLAT FLESH	Maintenance Crew's Skin color: 72004 (GC) ELF SKINTONE		
Flight Suit: 70875 (MC135) BEIGE BROWN	Maintenance Crew's Hair color: 70822 (MC168) BLACK GREY		
Shoes (both of them) Pilot's Gloves: 70985 (MC146) HULL RED	Maintenance Crew's Color of the Suit: 70880 (MC113) KHAKI GREY		
Pilot's Belt: 70975 (MC089) MILITARY GREEN	Maintenance Crew's Color: 70918 (MC005) IVORY		
Pilot's Metallic Details: 70997 (MC171) SILVER	Maintenance Crew's Cap badge: 70949 (MC010) LIGHT YELLOW		
Sole (both of them) Pilot's Goggles: 70861 (MC170) GLOSSY BLACK			
Pilot's Back: 70976 (MC120) BUFF			

◆ Assemble with Aircraft

1/32 TORYU Tei Instruction Manual P17 Front Seat How to Assemble

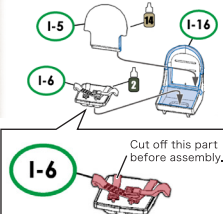

Aircraft model kit sold separately.