

### Attention!

- This item is meant for hobbyists 15 years of age or older. Please do not give this item to children under 15.
- This item is intended for use with the Zoukei-mura 1/32 "Kawasaki Ki-45 Kai TORUY".
- The polyethylene bags that contain the parts and assembly manual present a suffocation risk. Please do not drop the parts or bend them in unintended ways, as they may be damaged.
- In order to properly express the shape of the sculpt, it was unavoidable for some parts to have sharp edges. Please be careful.

### SUPER WING SERIES 1/32 KAWASAKI KI-45 Kai TORUY (NICK)

These are extra parts to be used with the "KI-45 Kai TORUY" kit.



## SUPER WING OPTIONS



## Weighted Tires

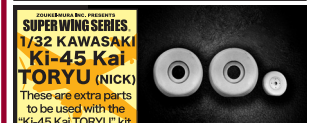

This is a resin kit. Please note that these parts cannot be glued with plastic model kit cement. Instant glue should be used instead.



### SUPER WING OPTIONS



### Weighted Tires



### ◆◆ Important Points for Assembly ◆◆

- Please carefully read the assembly manual prior to opening and make sure that everything is included.
- To use this item, tools such as ●Nippers, ●craft knife, ●files, ●sanding paper, ●instant glue, etc., are required, so please prepare them.
- Please prepare the parts first. You can remove seam lines and gate marks with tools such as nippers, a craft knife and files. Urethane resin is softer than the plastic material used for the kit, so be careful to avoid carving too much. Air bubbles can be filled with putty (epoxy, plastic, etc.) or similar, then finished with sanding paper. In the case that mold details are lost, you can recover them with tools such as spatulas.
- During assembly, adjust the orientation of each part while checking the balance and pose of the entire kit.
- Instant glue should be used for these parts. Please note that they cannot be glued with plastic model kit cement.
- We recommend using brass wire (sold separately) to reinforce the areas where the parts are glued together. Use a pin vice and drill bit to open a hole on both sides of each gluing surface, then insert the ends of a brass wire into the holes to connect the sides. This will greatly increase the strength of each joint. (Using the wires without glue to temporarily build a figure is called dry fitting. We recommend doing so in order to check each figure's balance.)
- Base preparation is required before painting. Please thoroughly finish the base with a coat of surface spray (otherwise, the paint will chip off as time passes).
- The recommended brand for painting your kit is the environment-friendly latest line of paint from Vallejo Color. Please refer to the Zoukei-mura 1/32 "Ki-45 Kai TORUY" Instruction Manual and Imperial Japanese Army historical manuals to paint the model with the coloring of your choice.

※When it comes time to use tools and paints, please carefully follow the individual instructions respective to each tool for your safety.

### Chart of Included Parts

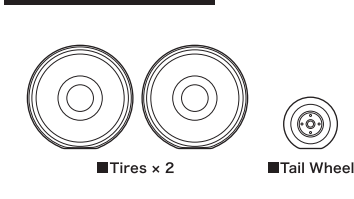

We take the utmost of care when overseeing manufacturing, but if your kit is among the very small percentage that contains a defective part, please contact customer service within two weeks of your purchase with your full name and order number.

Purchasers from VOLKS Japan International Web Site : Please contact imos@volks.co.jp.  
Purchasers from VOLKS USA : Please contact service@volksusa.com.

## 1/32 "Toryu" Assembly Instructions

\*These parts will be inserted when assembling the 1/32 "Toryu" kit. Please refer to the instruction manual of the "TORYU Tei". Page numbers may vary for Ko and Hei versions.

### ◆ Tail Wheel Attachment

Attach the tail wheel included in this set instead of part M-5. When attaching, follow the instructions below.

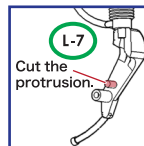

Before assembly, cut off this area from the plastic L-7 part.

### ■ Tail Wheel

Insert the tail wheel into parts L-7 and N-8 without gluing so that it can rotate.

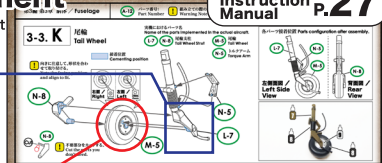

After Assembly  
Rotate the tail wheel so that the flattened side fits to the ground perfectly.

■ Tail Wheel  
This molding should be on the right side.

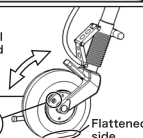

Ki-45 Kai TORUY Tei Instruction Manual P.27

### ◆ Main Wheels Attachment

Attach the tires included in this set instead of parts P-1 and P-2. Follow the instructions below to first attach the inner side wheel (Right: P-14, Left: P-23) to the strut.

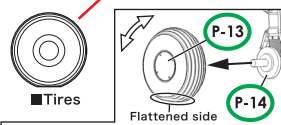

Attach tire to P-14 on the strut so the flattened side fits to the ground perfectly.

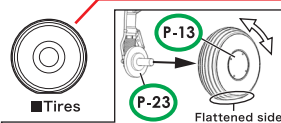

Attach tire to P-23 on the strut so the flattened side fits to the ground perfectly.

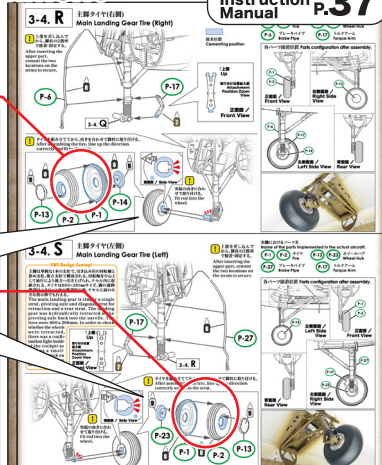

Ki-45 Kai TORUY Tei Instruction Manual P.37

Additionally affixing the separately sold "Metal struts" part will increase the stability and strength of the kit.