

Attention!

- This item is meant for hobbyists 15 years of age or older. Please do not give this item to children under 15.
- Please use these parts with the Zoukei-mura 1/48 "F-4 PHANTOM II" (C/D/J/S type) kit.
- The polyethylene bags that contain the parts and assembly manual present a suffocation risk. Please do not drop the parts or bend them in unintended ways, as they may be damaged.
- In order to properly express the shape of the sculptures, it was unavoidable for some parts to have sharp edges. Please be careful.

1/48
"F-4" For 1/48 "F-4" kit only.

造形村
ZOUKEI-MURA INC.
http://www.zoukeimura.co.jp/
Plan & Manufacturer: Zoukei-Mura, Inc.
Distributor: VOLKS, Inc.
http://www.volks.co.jp/en/
60 Zoukenouchi Nakamachi 2-chome-10, Shimogyo-ku, Kyoto, Japan 600-9862

SUPER WING OPTIONS
SWS48-04-M02
F-4 PHANTOM II 1/48
C/D/J/S
Weighted Tires



1/48
"F-4" For 1/48 "F-4" kit only.
造形村
ZOUKEI-MURA INC.
This is a resin kit. Please note that this kit is not to be glued with plastic model kit cement, instant glue, nor hot glue. Instead, please use the resin glue included.
©2011 ZOUKEI-MURA INC. All Rights reserved.

SUPER WING OPTIONS
SWS48-04-M02
1/48
"F-4" For 1/48 "F-4" kit only.
F-4 PHANTOM II
Can be used with C/D/J/S types.

1/48 C/D/J/S Weighted Tires
4 518992 529356

◆◆Important Points for Assembly◆◆

- Before opening the bag, please carefully read this instruction manual and verify that all the parts are included. This set is for the Zoukei-mura 1/48 "F-4" C/D/J/S kits. When using this set, please also read the Instruction Manual of the plane's type on which you would like to attach these parts.
- To use this item, tools such as ●nippers, ●craft knife, ●files, ●sanding papers, ●instant glue, etc., are required, so please prepare them.
- Please prepare the parts first. You can remove "parting lines" and "gate marks" with tools such as nippers, craft knives and files. Urethane resin is softer than the plastic material used for the kit, so be careful to avoid carving too much. Air bubbles can be filled with putty (epoxy, plastic, etc.) or similar, then finished with sanding paper. In case that mold details are lost, you can recover them with tools such as spatulas.
- During the assembly, adjust each part's angle of attachment while checking the balance and pose of the entire kit.
- Please use instant glue for cementing these parts. Please note that these parts cannot be glued with plastic model kit cement.
- Process the surface of the parts before painting. Please prepare the surface of the parts by spraying a surface on the entire surface (otherwise, the paint may peel as time passes).
- The recommended brand for painting your kit is the latest line of acrylic paint from Vallejo Color. Please refer to the Zoukei-mura 1/48 "F-4 PHANTOM II" C/D/J/S Instruction Manual, Color Guides and U.S. Forces historical manuals to paint the model with the coloring of your choice.

※ Before using tools and paints, please carefully read their instructions manuals and use them safely.

Chart of Included Parts

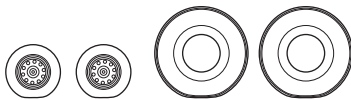

■ Nose Wheel x 2

■ Main Tire x 2

We take the utmost of care when overseeing manufacturing, but if your kit is among the very small percentage that contains a defective part, please contact customer service within two weeks of your purchase with your full name and order number.

Purchasers from VOLKS
Japan International Web Site:
Please contact imos@volks.co.jp.
Purchasers from VOLKS USA:
Please contact service@volksusa.com.

1/48 "F-4" Assembly Instructions

Attach this set's parts when assembling the 1/48 "F-4" C/D/J/S kit. The following explanations are in case you use these parts with the 1/48 "F-4J" type. Please adjust the assembly to your kit.

◆ Nose Wheel Attachment

1/48 F-4J
Instruction Manual P19

When you assemble the nose wheel, instead of parts E-17 attach the "Nose Wheels" of this set according to the instructions.

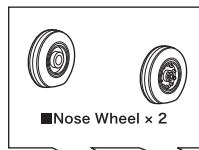

■ Nose Wheel x 2

※ The instructions on the right are for the J type. The page and section numbers of other types may be different, so please check carefully before assembly.

Adjust and assemble the parts in order the flat surface of the wheels touch the ground.

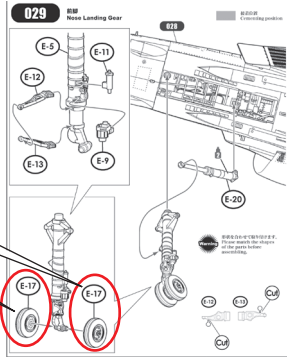

◆ Main Wheel Attachment (Right Side)

1/48 F-4J
Instruction Manual P20

When you assemble the right main wheel, instead of part E-3 attach the "Main Tire" of this set according to the instructions.

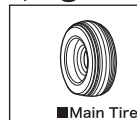

■ Main Tire

Adjust and assemble the part in order the flat surface of the wheel touch the ground.

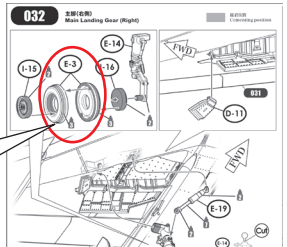

◆ Main Wheel Attachment (Left Side)

1/48 F-4J
Instruction Manual P21

When you assemble the left main wheel, instead of part E-3 attach the "Main Tire" of this set according to the instructions.

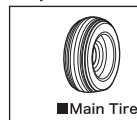

■ Main Tire

Adjust and assemble the part in order the flat surface of the wheel touch the ground.

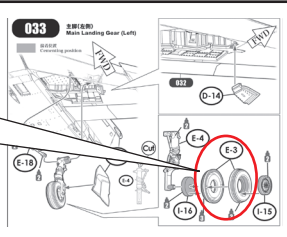

Additionally affixing the separately sold "Metal Struts" parts will increase the stability and strength of the kit.