

Attention!

- This item is meant for hobbyists 15 years of age or older. Please do not give this item to children under 15.
- Please use these parts with the Zoukei-mura 1/48 F-4 PHANTOM II (E/EJ/F/G types) kit.
- The polyethylene bags that contain the parts and assembly manual present a suffocation risk. Please do not drop the parts or bend them in unintended ways, as they may be damaged.
- In order to properly express the shape of the scoules, it was unavoidable for some parts to have sharp edges. Please be careful.

This kit is made of white metal. Please note that these parts cannot be glued with plastic model kit cement. Instant glue should be used instead.

SUPER WING OPTIONS



SWS48-10-M01

F-4 PHANTOM II 1/48

E/EJ/F/G Metal Struts

1/48 F-4/EJ/F/G Long Nose



For 1/48 "F-4" kit only.

造形村 ZOUKEI-MURA INC.



Image for illustrative purposes only.

©ZOUKEI-MURA INC. All Rights reserved.



www.zoukei-mura.co.jp/en/
Plan & Design : Zoukei-Mura, Inc.
Manufacturer : MDC
Distributor : VOLKS, Inc.
60 Gatonouchi Nakamachi
Shiich-jo, Shimogyo-ku, Kyoto
Japan 600-8862

F-4 E/EJ/F/G Metal Struts



4 518992 229966

◆◆ Important Points for Assembly ◆◆

- Before opening the bag, please carefully read this instruction manual and verify that all the parts are included. This set is for the Zoukei-mura 1/48 "F-4" E Early / E Late / EJ / EJ Kai / F / F ICE / G kits. When using this set, please also read the Instruction Manual of the plane's type on which you would like to attach these parts.
- To build this kit, a big pincher, a cutting knife, sandpaper, waterproof sandpaper, instant glue, and Metal Primer spray are required. Please make sure they are at hand before starting your work.
- This kit is made of white metal. Parts should be refined. After removing parts' gates with big nippers, remove flash with files and polish the surface with waterproof sandpaper. Because the blade of nippers might break up, please use caution. After roughly sharpening the "parting lines" with the cutting knife and the sandpaper, clean up and polish the surface with waterproof sandpaper. Be careful not to damage the parts.
- To fix the parts of the kit, please use instant glue. Please do not use glue dedicated to plastic models.
- Before painting, make a primer coat using the Metal Primer. (Without primer coat, paint may peel.)
- The recommended brand for painting your kit is the latest line of acrylic paint from Vallejo Color. Enjoy painting in the color scheme of your choice, based on the Zoukei-Mura 1/48 F-4 manuals and your own reference materials.

※Please carefully use the tools and the solvents used for assembly and painting by referring to their instruction manuals.

Chart of Included Parts

- ① Nose Landing Gear Strut
- ② Main Landing Gear Strut (Right)
- ③ Main Landing Gear Strut (Left)
- ④ Nose Strut Actuator
- ⑤ Right Main Strut Actuator
- ⑥ Left Main Strut Actuator
- ⑦ Torque Arm Upper Part
- ⑧ Torque Arm Lower Part
- ⑨ Nose Strut Part 1
- ⑩ Nose Strut Part 2

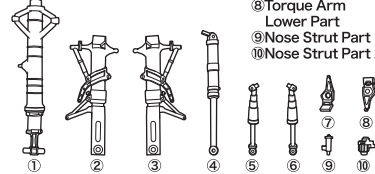

We take the utmost of care when overseeing manufacturing, but if your kit is among the very small percentage that contains a defective part, please contact customer service within two weeks of your purchase with your full name and order number.

Purchasers from VOLKS
Japan International Web Site:
Please contact imos@volks.co.jp.
Purchasers from VOLKS USA:
Please contact service@volksusa.com.

1/48 "F-4" Assembly Instructions

Attach this set's parts when assembling the 1/48 "F-4" E/EJ/F/G kit. The following explanations are in case you use these parts with the 1/48 "F-4E Early type". Please adjust the assembly to your kit.

◆ Nose Strut Attachment

Use these parts in place of the original parts included in the kit.

※The instructions on the right are for the E Early type. The page and section numbers of other types may be different, so please check carefully before assembly.

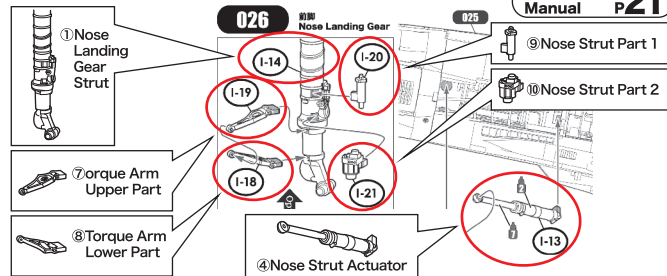

1/48 F-4E Instruction Manual P21

◆ Right Main Strut Attachment

Use these parts in place of the original parts included in the kit.

029 主翼(右側) Main Landing Gear (Right)

