

3-4. Engine Equipping

Equipping the Engine

 Warning Note When Assembling

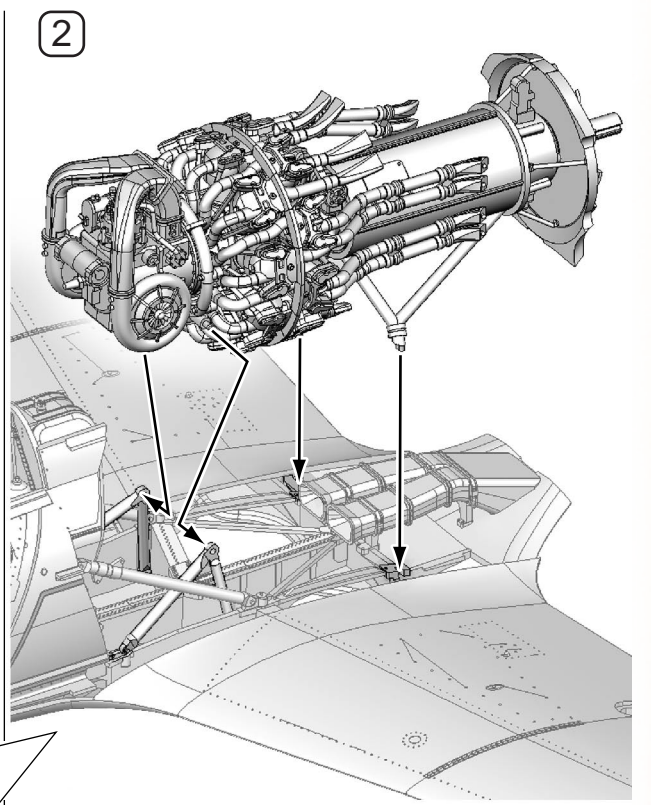
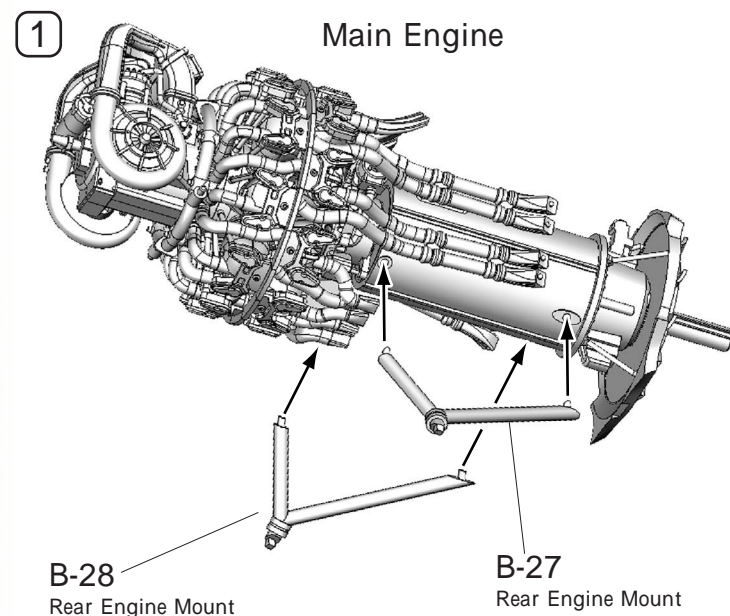
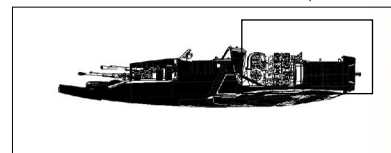

Position for gluing parts

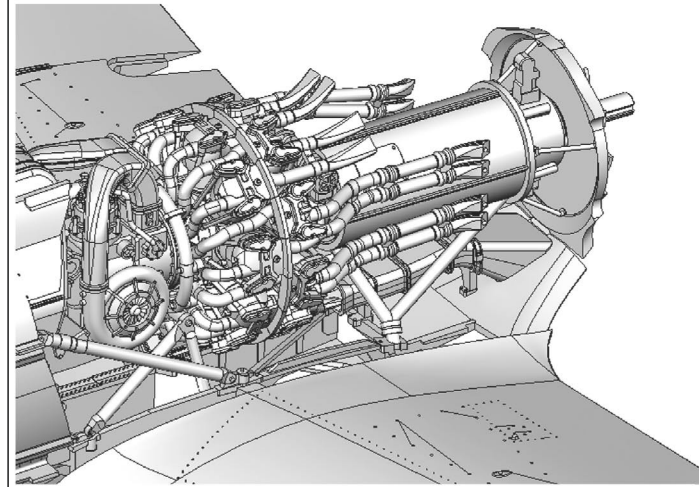

Position for gluing parts:
top view

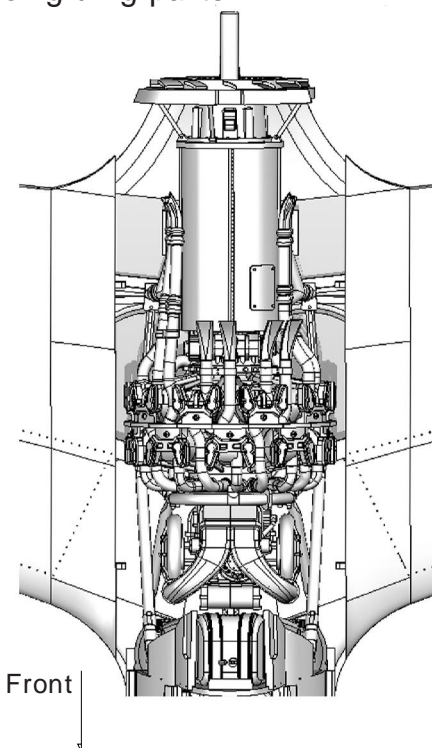

Position for gluing parts:
side view

 Fix it firmly to the main frame through the engine mount.

Front

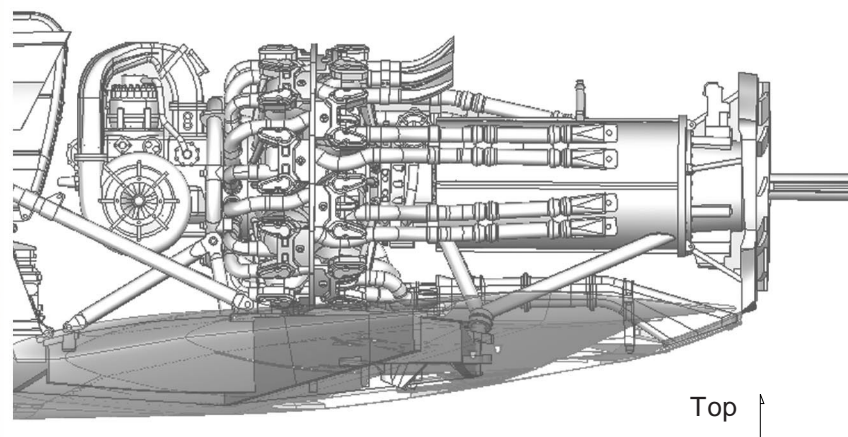



Top

Front

3-4. Engine Equipping

Oil Cooler + Side Panels

 Paint Number  Warning Note When Assembling

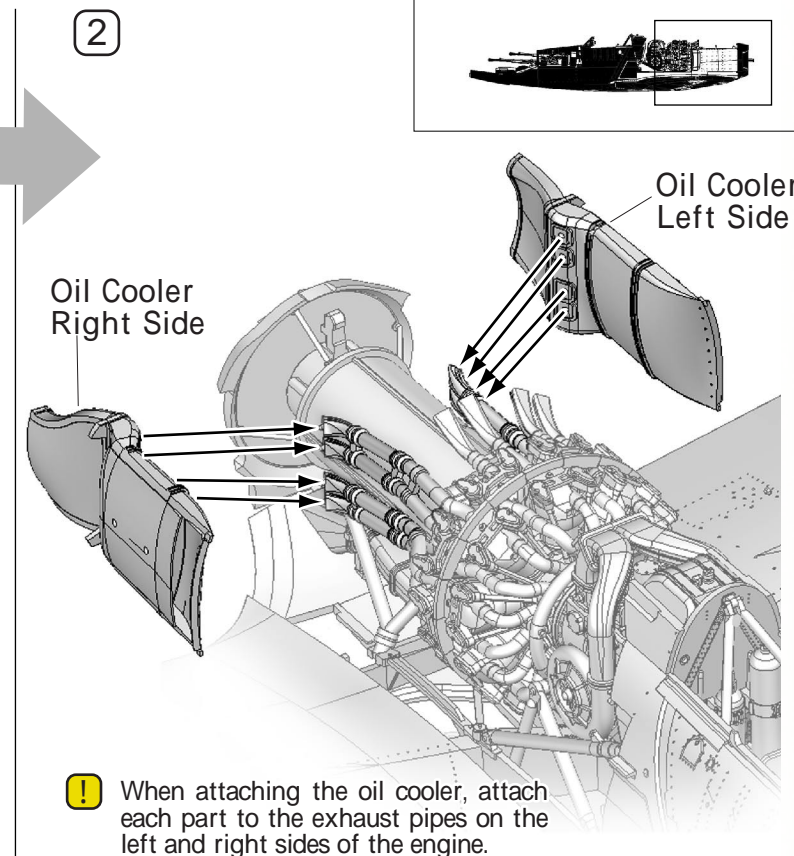
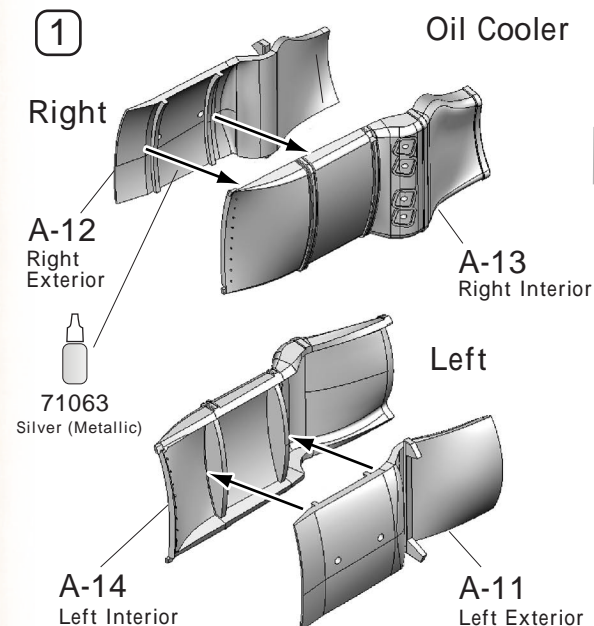
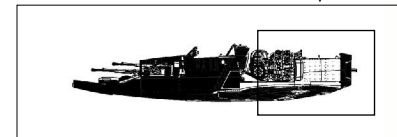

③  Attach the side panels to the oil cooler.

