

Treating & Installing the Hinges

1 The comb-like parts must be treated before they can be joined together. With the aim being to run 0.5mm brass wire (sold separately) through the pipeline, curl the "teeth" of the comb into round pipes. Do this for both parts before connecting them.

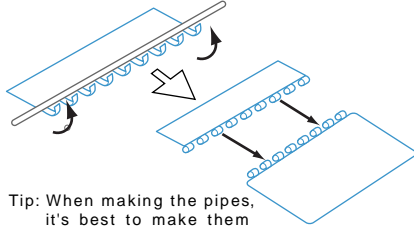

Tip: When making the pipes, it's best to make them a little wide, so that it's easy for the brass wire to run through.

2 After connecting the parts, insert a brass wire (sold separately) down the channel, then glue. (Make sure to cut the brass wire to length.) As these parts are not very strong, it is exceedingly easy to damage them, so we recommend gluing as fast as possible once you've adjusted the hinge to your preferred angle. (The parts are not movable like an actual hinge.)

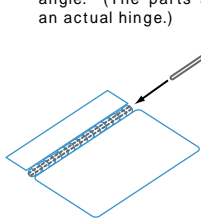

Sold separately:
Brass wire
Please purchase approximately 0.5mm-diameter wire separately.

Refer to the P-51D's manual **p21.**

III-4. **Da Engine Cowling**

DO NOT GLUE!
Use as a template without gluing.

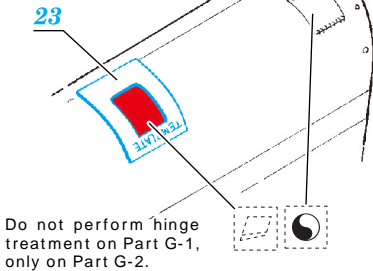

Do not perform hinge treatment on Part G-1, only on Part G-2.

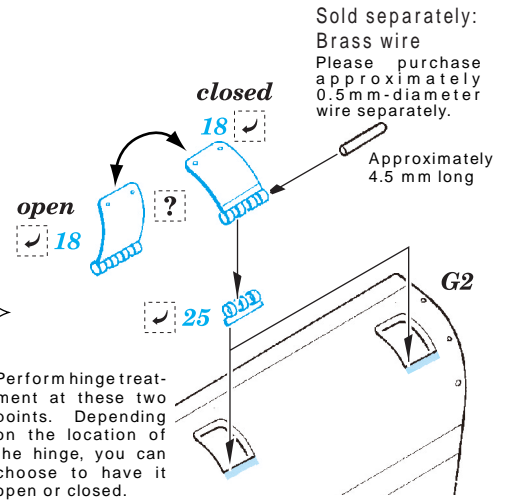

Performing hinge treatment at these two points. Depending on the location of the hinge, you can choose to have it open or closed.

Refer to the P-51D's manual **p30.**

III-6. **B Wing Fillet**

DO NOT GLUE!
Use as a template without gluing.

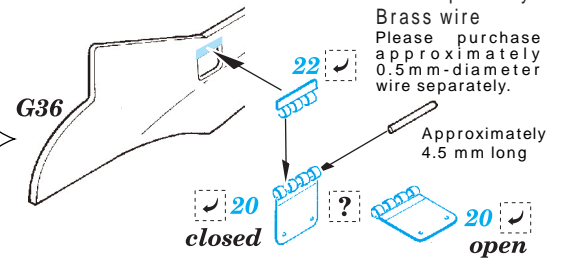
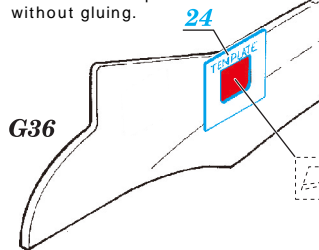

Depending on the location of the hinge, you can choose to have it open or closed.

Refer to the P-51D's manual **p21.**

III-4. **E Air Filter Panel**

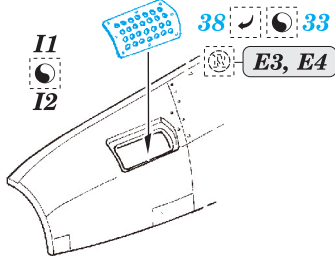

Refer to the P-51D's manual **p22.**

III-4. **H Vertical Stabilizer**

After opening the 4 holes in each side, join the two sides together with the part on the inside.

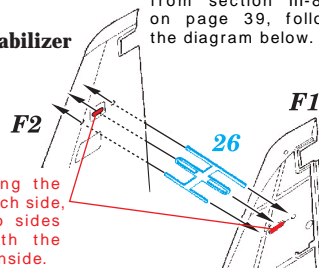

In the case that you are attaching the rear warning radar from section III-8.F on page 39, follow the diagram below.

Rudder

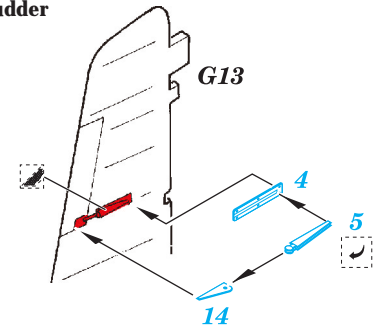

Refer to the P-51D's manual **p27.**

III-5. **G Flaps**

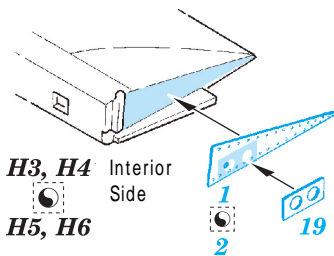

Refer to the P-51D's manual **p28.**

III-5. **I Ailerons**

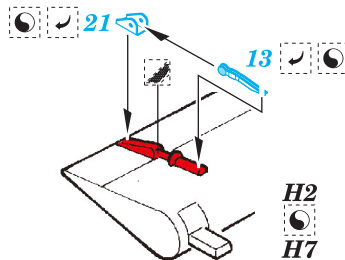

Refer to the P-51D's manual **p31.**

III-7. **D Radiator Outlet Door**

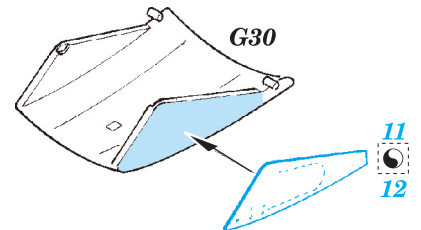

Refer to the P-51D's manual **p33.**

III-7. **A Main Gear Strut**

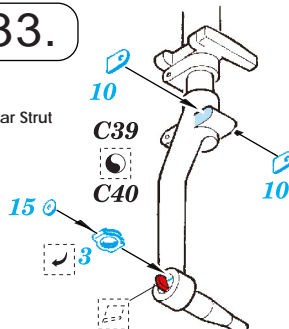

Refer to the P-51D's manual **p35.**

III-7. **H Auxiliary Combat Tank (75U.S.gal.)**

