

Attention!

- This item is meant for hobbyists 15 years of age or older. Please do not give this item to children under 15.
- This item is intended for use with the Zoukei-mura 1/32 "Mustang IV".
- The polyethylene bags that contain the parts and assembly manual present a suffocation risk. Please do not drop the parts or bend them in unintended ways, as they may be damaged.
- In order to properly express the shape of the sculpts, it was unavoidable for some parts to have sharp edges. Please be careful.

SUPER WING SERIES

These are extra parts to be used with the "1/32 Mustang IV" kit.



ZOUKEI-MURA INC. MASTER BOX LTD.
<http://www.zoukeimura.co.jp/>
 Plan & Manufacturer : Zoukei-Mura, Inc.
 Design : MASTE BOX LTD
 Distributor : VOLKS, Inc.
<http://www.volks.co.jp/en/index.aspx>
 60 Goshonouchi Nakamachi 5-chome-1
 Shimogyo-ku, Kyoto Japan 600-8862

SUPER WING OPTIONS

ZOUKEI-MURA INC. PRESENTS
SUPER WING SERIES. No.09 [SWS09-F01]
VS/VIP Limited

1/32 Mustang IV
P-51D/K

Limited Forward Facing Pilot Figure



These parts are made of urethane resin. Please be careful during assembly.

Plastic model cement won't work on these parts. Please use a suitable instant glue.

ZOUKEI-MURA INC. All Rights reserved.
 Plan & Manufacturer : Zoukei-Mura, Inc.
 Design : MASTE BOX LTD
 Distributor : VOLKS, Inc.

SUPER WING OPTIONS
 1/32 Mustang IV P-51D/K
 1/32 Mustang IV
 These are extra parts to be used with the "1/32 Mustang IV" kit.

Limited Forward Facing Pilot Figure

 4 518992 224602

1/32 "Mustang IV" Assembly & Treatment Instructions

Please build along with the 1/32 "Mustang IV" kit. Please also refer to the 1/32 "Mustang IV" assembly manual.

Refer to the 1/32 P-51D's manual **p13**

III-2. B Pilot Seat

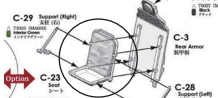

Choose part C-23 (without seatbelt), and assemble.

Refer to the 1/32 P-51D's manual **p30**

III-6. A Control Stick

Please proceed as explained depending on the control stick you chose (part C-26 or C-24). Without fixing the control stick to the right hand of the pilot, first match the shapes of the parts, and then attach the control stick to the aircraft structure (main wings).

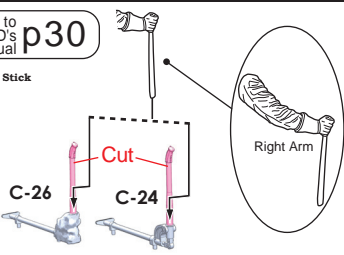

RAF Pilot Assembly

Assemble the RAF pilot as shown. Please check carefully the assembly before mounting up the parts.

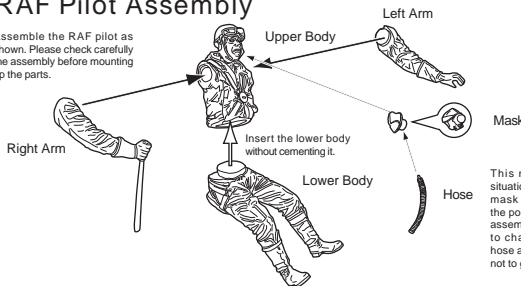

This mask reproduces the situation when the pilot has the mask off. Please make sure the position of the parts before assembly. You can use a dryer to change the shape of the hose as you prefer. (Be careful not to get injured.)

RAF Pilot Insertion

Sit the RAF pilot into the 1/32" Mustang IV kit you have already assembled.

First insert only the lower part of the body into the aircraft. Insert the pilot until his feet sit on the rudder pedals.

Attach the upper part of the pilot's body to the lower part, so as to sit the pilot inside the aircraft.

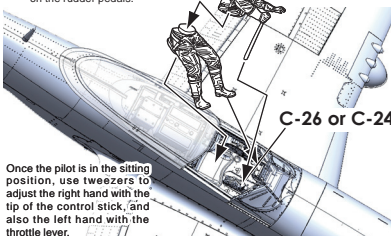

Once the pilot is in the sitting position, use tweezers to adjust the right hand with the tip of the control stick, and also the left hand with the throttle lever.

Figure Positioning

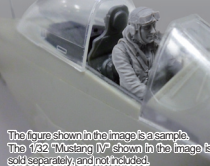

The figure shown in the image is a sample. The 1/32 "Mustang IV" shown in the image is sold separately and not included.

Important Points for Assembly

Please carefully read the assembly manual prior to opening and make sure that everything is included.

To use this item, tools such as nippers, craft knife, files, sanding papers, instant glue, etc., are required, so please prepare them.

Please prepare the parts first. You can remove seam lines and gate marks with tools such as nippers, a craft knife and files. Urethane resin is softer than the plastic material used for the kit, so be careful to avoid carving too much. Air bubbles can be filled with putty (epoxy, plastic, etc.) or similar, then finished with sanding paper. In the case that mold details are lost, you can recover them with tools such as spatulas.

During assembly, adjust the orientation of each part while checking the balance and pose of the entire kit.

Instant glue should be used for these parts. Please note that they cannot be glued with plastic model kit cement.

We recommend using brass wire (sold separately) to reinforce the areas where the parts are glued together. Use a pin vise and drill bit to open a hole on both sides of each gluing surface, then insert the ends of a brass wire into the holes to connect the sides. This will greatly increase the strength of each joint. (Using the wires without glue to temporarily build a figure is called dry fitting. We recommend doing so in order to check each figure's balance.)

Base preparation is required before painting. Please thoroughly finish the base with a coat of surfacer spray (otherwise, the paint will chip off as time passes).

With regard to paint, after taking personal safety and the global environment into consideration, we recommend using "Vallejo Colors", acrylic hobby paints for the new century. Please check historical references regarding the UK RAF and the assembly manual of the 1/32 "Mustang IV", and finish your Mustang in your preferred color scheme.

When it comes time to use tools and paints, please carefully follow the individual instructions responsive to each tool for your safety.

Chart of Included Parts

RAF Pilot



We take the utmost of care when overseeing manufacturing, but if your kit is among the very small percentage that contains a defective part, please contact customer service within two weeks of your purchase with your full name and order number.

Purchasers from VOLKS Japan International Web Site:
 Please contact imos@volks.co.jp.
 Purchasers from VOLKS USA:
 Please contact service@volksusa.com.