

# SUPER WING OPTIONS

1/48  
No.3

## Horten Ho 229

### Photo-Etched Parts Interior & Air Brake Set

#### ◆◆Important Points for Assembly◆◆

- For use of this part, please refer to the Instruction Manual of the 1/48 "Horten Ho 229" and prepare the required tools.
- Please use nippers for etching parts when cutting off the etching parts. Tweezers may also be very useful when handling the parts you cut and attaching them to the kit.
- Please use instant glue for cementing these parts. Please note that these parts cannot be glued with plastic model kit cement. Before painting the parts, please spray a coat of metal primer (otherwise, the paint may peel as time passes).
- The recommended brand for painting your kit is the latest line of paint from Vallejo Color. Please refer to the Zoukei-mura 1/48 "Horten Ho 229" Instruction Manual and Luftwaffe historical manuals to paint the model with the coloring of your choice.
- ※ Before using tools and paints, please carefully read their instructions manuals and use them safely.

We take the utmost of care when overseeing manufacturing, but if your kit is among the very small percentage that contains a defective part, please contact customer service within two weeks of your purchase with your full name and order number.

Purchasers from VOLKS Japan International Web Site:  
Please contact imos@volks.co.jp.  
Purchasers from VOLKS USA: Please contact service@volksusa.com.

Please note that items which have been opened, or worked with, can't be exchanged. Thank you for your understanding.

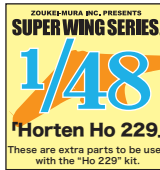
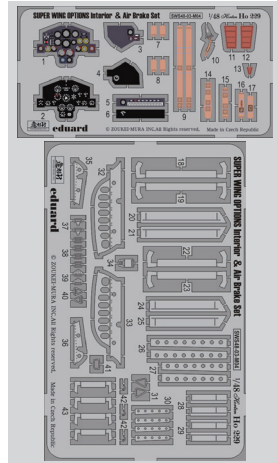

These are photo-etched parts. Please note that these parts cannot be glued with plastic model kit cement. Instant glue should be used instead.

SWS48-03-M04

#### ⚠ Attention!

- This item is meant for hobbyists 15 years of age or older. Please do not give this item to children under 15.
- This item is intended for use with the Zoukei-mura 1/48 "Horten Ho 229".
- The polyethylene bags that contain the parts and assembly manual present a suffocation risk. Please do not drop the parts or bend them in unintended ways, as they may be damaged.
- In order to properly express the shape of the sculpts, it was unavoidable for some parts to have sharp edges. Please be careful not to hurt yourself. Also, please do not give these parts to small children.

■ Plan & Design : Zoukei-Mura, Inc. ■ Manufacturer : Eduard

■ Distributor : VOLKS, Inc. <http://www.volks.co.jp/en/>

60 Goshonouchi Nakamachi Shichi-jo, Shimogyo-ku, Kyoto Japan 600-8862 ©ZOUKEI-MURA INC. All Rights reserved. Made in Czech Republic



#### Marks Used in the Instructions

- Do the same for left and right.
- Cut off.
- Bend.
- Scrape away.
- Choose one.
- Make a hole.
- Replace the default part.

#### Colors Used in the Instructions

- Parts of the kit.
- Parts of this Photo-Etched Set.
- Cut off this area.
- Fill this opening with a putty, or similar.

1/48 Horten Ho 229  
Instruction Manual p.11

017

コックピット側面フレーム  
Cockpit Side Frame

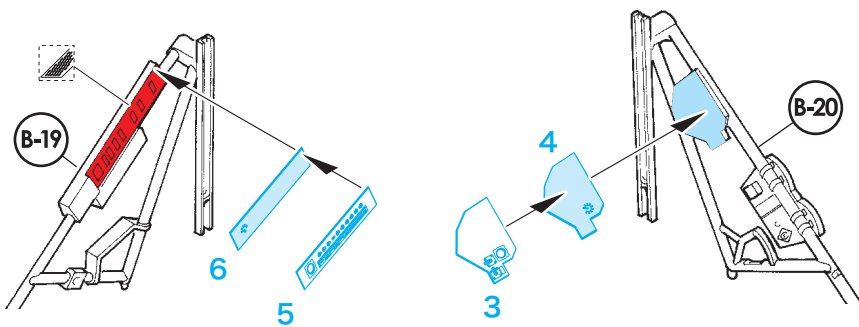

018

計器盤  
Instrument Panel

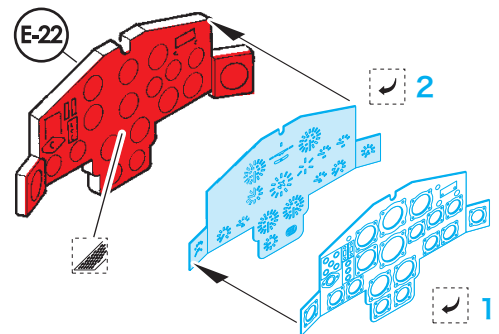

1/48 Horten Ho 229  
Instruction Manual p.13

023

エアブレーキ  
Air Brake

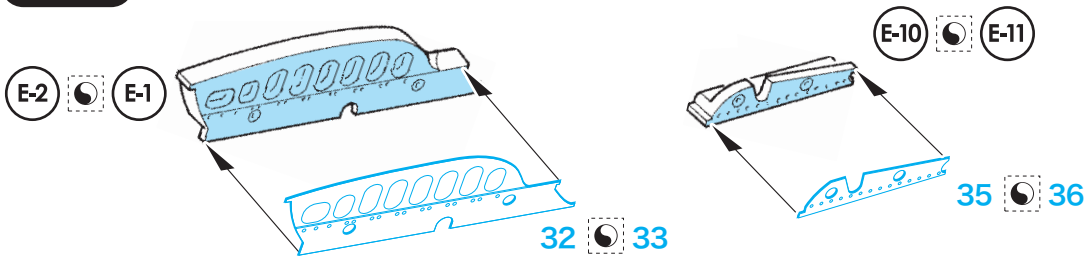

1/48 Horten Ho 229  
Instruction Manual p.15

030

ドラッグラダー(右翼)  
Drag Rudder (Right)

