

SWS 'He 219 A-0 Uhu' Points of Advice

Installing Each Part of the Landing Gears

No.1
Nose
Landing
Gear

Nose Landing Gear Assembly Position

Please note that in order to make this explanation easier to understand, the illustration is drawn with one part removed.

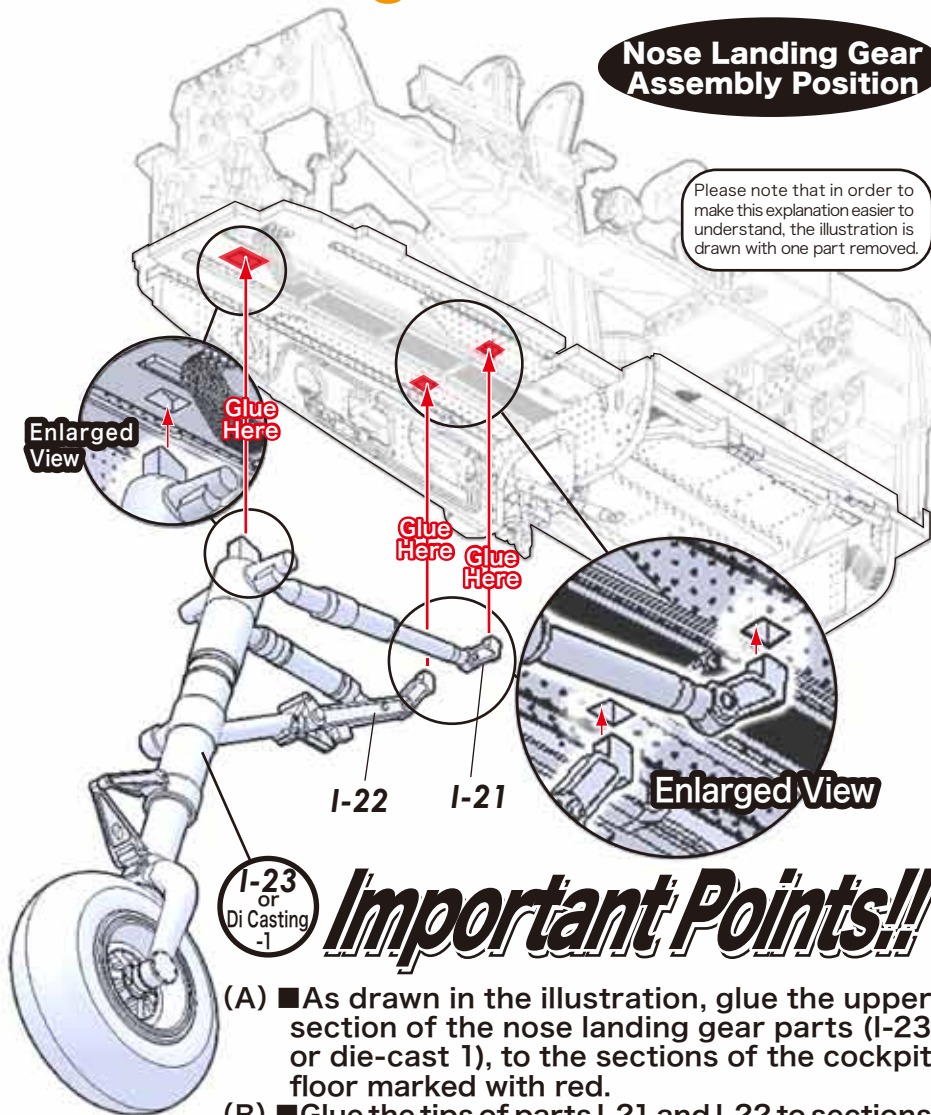

Important Points!!

- (A) ■ As drawn in the illustration, glue the upper section of the nose landing gear parts (I-23, or die-cast 1), to the sections of the cockpit floor marked with red.
- (B) ■ Glue the tips of parts I-21 and I-22 to sections of the cockpit floor marked with red.

Side View of Installed Nose Landing Gear

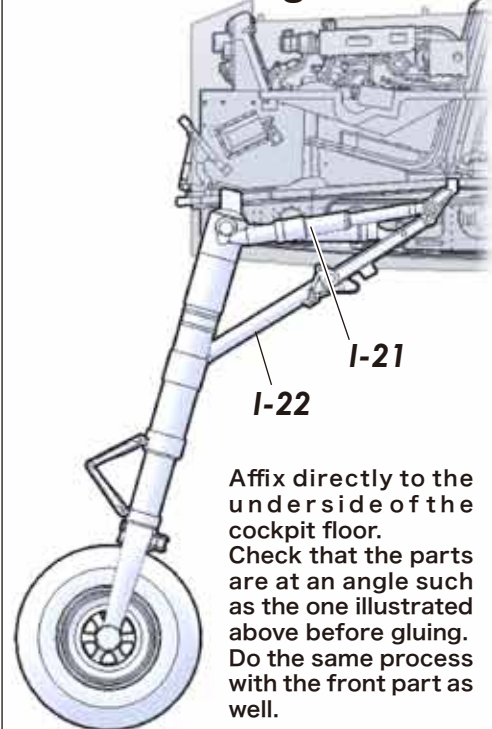

Front View of Installed Landing Gear Covers

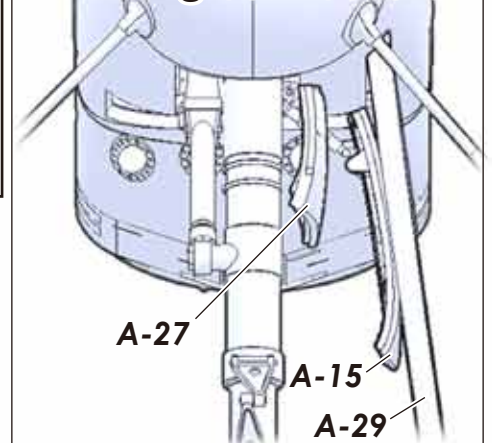

Landing Gear Covers Assembly

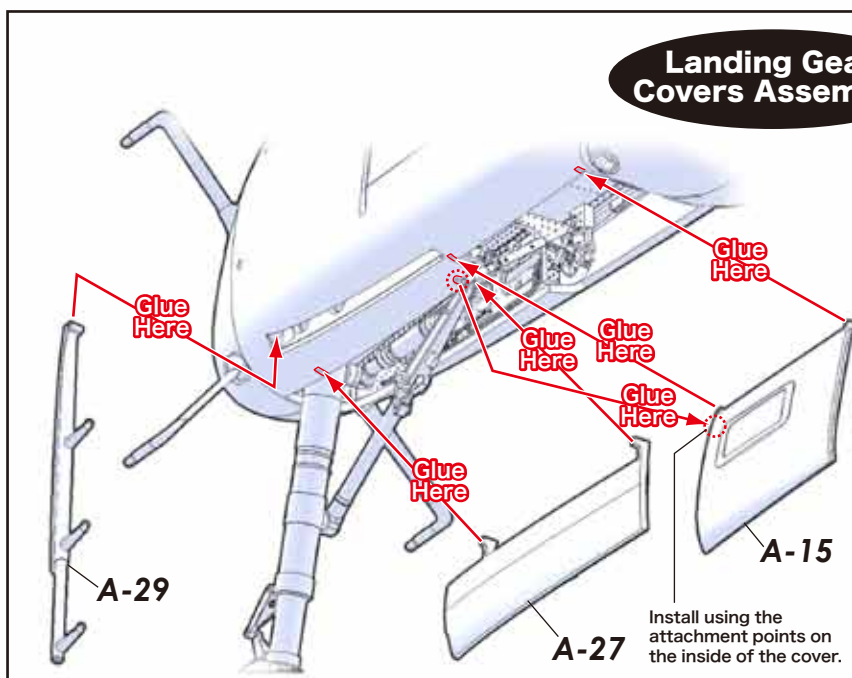

Side View of Installed Landing Gear Covers

